

Yumoto

MOTO
SERIES
系列注塑成型机
PLASTIC INJECTION MOLDING MACHINE



Yumoto

为客户提供优质注塑机

Provide customers with high-quality injection molding machines



Mission

公司使命

缩小与欧美品牌注塑机的差距, 将誉腾精机打造成中国乃至世界知名品牌

Narrow the gap with European and American brand injection molding machines, build Yumoto machinery into a well-known brand in China and even in the world

Corporate Culture

公司的企业文化

包容 反思 进取 奉献

Inclusiveness, Self-examination, Enterprising, Dedication

Values

公司价值观

帮客户实现价值最大化

Help customers maximize value

Features

公司的特点

技术主导+贴近市场+严格品控+快速售后

Technology-led+ Close To Market + Strict Quality Control+ Fast Aftersales

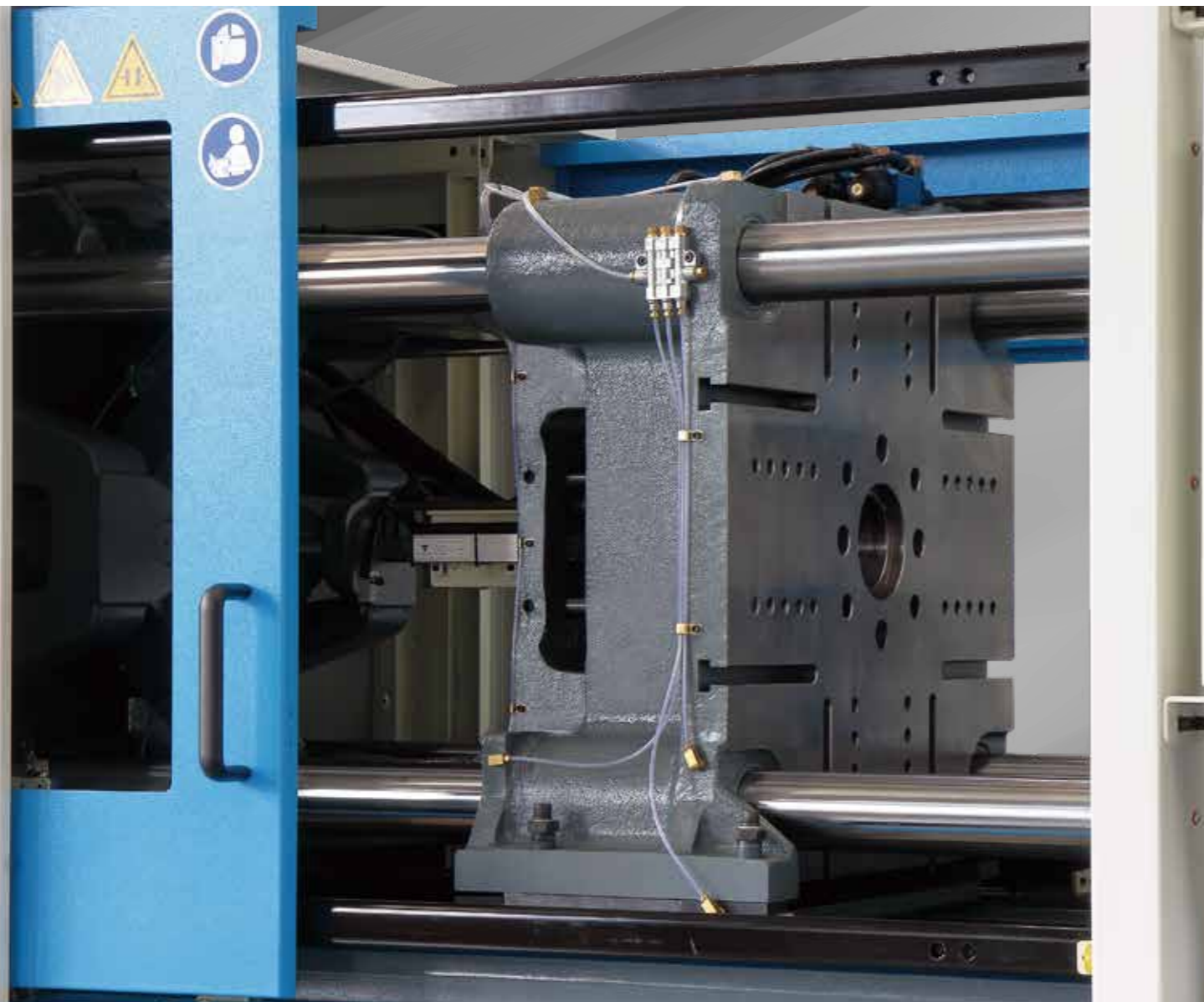

大开距、高刚性的合模单元

Large Open Distance And High Rigidity Clamping Unit

- 加长、加宽的导向支撑, 重复精度更高, 大幅度提升产品质量和模具使用寿命。
Longer and wider guide support, higher repeat accuracy, improving molded product quality and molds lifespan largely.
- 更大的拉杆间距, 可适应更多的模具尺寸范围和产品多腔化的需求。
Larger space between tie bar, adaptable to more sizes of molds and multi-cavity demands.
- 配置升级, 拉杆、顶出导向套采用含石墨铜套, 二板、尾板滑脚采用自润滑合金滑板, 确保快速、精确开锁模。
Key guiding parts for tie bar, ejectors are upgraded with graphite copper bushes. And self-lubricating alloy sliding plate are used on the movable platen and rear platen. Mold opening and locking is fast and precise.
- 整体机械刚性大大超出同行, 不仅仅提升机器使用寿命, 还能有效的保护模具。
The overall mechanical rigidity far exceeds that of other suppliers, which not only improves the service life of the machine, but also effectively protects the mold.
- 欧式顶出结构, 空间更大, 维护更方便。
European-style ejector structure, larger space, more convenient maintenance.
- 机械结构、连杆设计更优化, 运行速度更加快速、平稳、效率提高。
The mechanical structure and connecting rod design are more optimized, the running speed is faster, more stable, and the efficiency is improved.

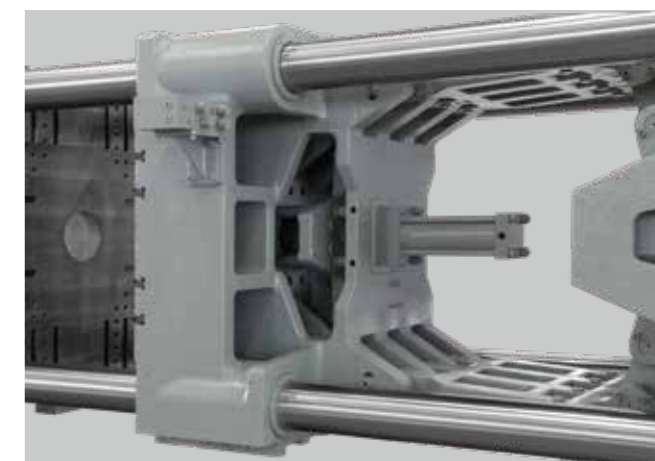

CLAMPING UNIT

合模部分

INJECTION UNIT

注射部分

低惯量、高精度的注射单元

Low Inertia And High Precision Injection Unit

- 上翻式射嘴防护罩, 生产及维护更加简单。

The flip-up nozzle protective cover makes production and maintenance easier.

- 双射移注射结构, 进一步提升注射精度。

Dual carriage structure improves the accuracy of injection.

- 过胶头、过胶圈、过胶垫圈采用高品质进口材料SKD61; 品种齐全的螺杆设计, 可充分满足不同塑料原料及特殊加工要求的注塑成型。

The screw tip, check ring and screw washer are made from imported high quality material SKD61. Variety of screw design are able to meet the needs of different plastic material and special processing injection molding.

- 采用整体射台支撑结构配合精密的双线性导轨, 确保精密、快速的动作响应。

The overall support structure of injection unit with precise dual linear guide rails ensures precise and fast action response.

- 射台钢管采用接头连接, 无焊接设计使得维护、售后更加简单。

Steel tubes of injection unit are connected by fittings without welding, easy maintenance and after sales service.





- 机器程序均根据欧洲安全标准设计, 保护操作人员的安全。
The machine program is are designed according to European safety standards to protect the operators.
- 电箱、接线盒处采用降噪、防水海绵条, 确保设备的安全性。
Noise-reduction and water-proof sponge are used on electric cabinet and junction boxes to ensure the safety of the machine.
- 可实现现代化联网管理功能, 同用户MES系统配合做数据对接。
It can realize modernized computer network management as well as data docking to user's MES system.
- 高品质彩色液晶控制器, 和动力系统厂家合作研发, 配合更好, 响应速度更快。
High quality color LCD controllers are developed with the power system manufacturers. It has faster response by better coordination with power system.



ELECTRIC UNIT

电气部分

HYDRAULIC UNIT

液压部分



- 标配精密节能伺服系统, 与传统注塑机相比节能效果可达20%~80%。
Equipped with precise energy-saving servo system, saving 20%~80% energy compared with traditional injection molding machine.
- 采用进口知名品牌液压部件, 确保机器的可靠性和快速响应。
Imported well-known brand hydraulic components are used to ensure the reliability and quick response of the machine.
- 采用DIN标准锥面带密封圈接头, 阀板采用G螺纹密封堵头, 杜绝油污污染。
Use DIN standard cone seal fittings and valve plates with G thread sealing plug to prevent oil pollution.
- 液压部分采用模块化设计, 提高系统灵活性。
Hydraulic system adopts modular design to improve system flexibility.



MOTO-110

参数	PARAMETER	UNIT	A	B	C	D
国际公认型号	International Size Rating		340			
注射部分 INJECTION UNIT						
螺杆直径	Screw Diameter	mm	32	35	38	42
螺杆长径比	Screw L/D Ratio	L/D	23	21	19.3	17.5
理论注射容量	Injection volume(theoretical)	cm ³	137	164	193	236
注射重量 (PS)	Injection weight(PS)	g	124	149	175	214
注射速率	Injection rate	g/s	77	91	109	132
注射压力	Injection pressure	Mpa	249	208	176	144
螺杆转速	Screw speed	r/min	0-250			
合模部分 CLAMPING UNIT						
合模力	Clamping force	KN	1100			
移模行程	Mold opening stroke	mm	360			
拉杆间距	Space Between Tie Bars	mm	425x375			
最大模厚	Max.Mold Height	mm	400			
最小模厚	Min.Mold Height	mm	150			
顶出行程	Ejector stroke	mm	100			
顶出力	Ejector tonnage	KN	50			
其它 OTHERS						
油泵电机功率	Oil pump motor power	kw	11.5			
电热功率	Heater Power	kw	6.9			
外形尺寸	Machine dimension(LxWxH)	m	4.3x1.2x1.6			
机器重量	Machine weight	t	3.8			
料斗容积	Hopper capacity	kg	25			

机器尺寸 Machine dimensions

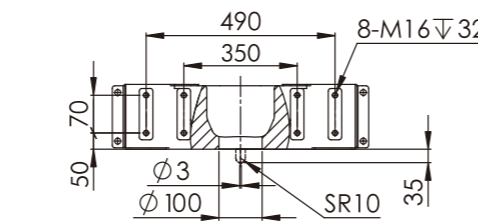
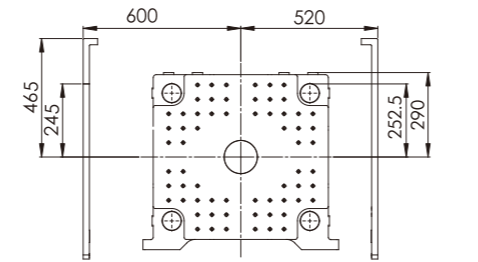
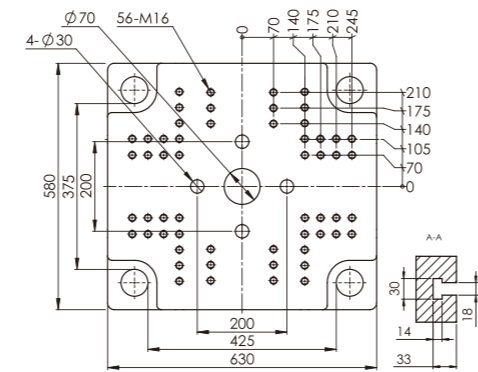

外形尺寸 Machine dimension

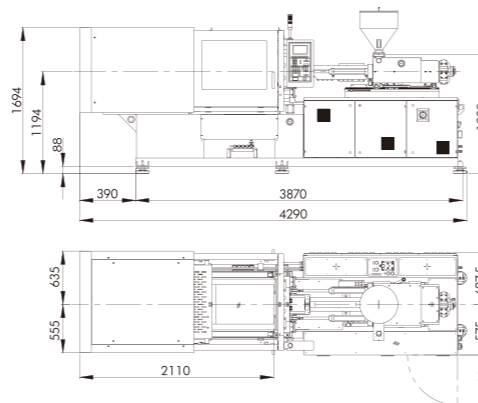

MOTO-150

参数	PARAMETER	UNIT	A	B	C
国际公认型号	International Size Rating		480		
注射部分 INJECTION UNIT					
螺杆直径	Screw Diameter	mm	38	42	45
螺杆长径比	Screw L/D Ratio	L/D	23	21.2	19.8
理论注射容量	Injection volume(theoretical)	cm ³	227	277	318
注射重量 (PS)	Injection weight(PS)	g	206	252	289
注射速率	Injection rate	g/s	107	151	184
注射压力	Injection pressure	Mpa	233	190	166
螺杆转速	Screw speed	r/min	0-250		
合模部分 CLAMPING UNIT					
合模力	Clamping force	KN	1500		
移模行程	Mold opening stroke	mm	410		
拉杆间距	Space Between Tie Bars	mm	470x420		
最大模厚	Max.Mold Height	mm	500		
最小模厚	Min.Mold Height	mm	160		
顶出行程	Ejector stroke	mm	120		
顶出力	Ejector tonnage	KN	50		
其它 OTHERS					
油泵电机功率	Oil pump motor power	kw	15		
电热功率	Heater Power	kw	10.1		
外形尺寸	Machine dimension(LxWxH)	m	4.66x1.28x1.72		
机器重量	Machine weight	t	4.2		
料斗容积	Hopper capacity	kg	25		

机器尺寸 Machine dimensions

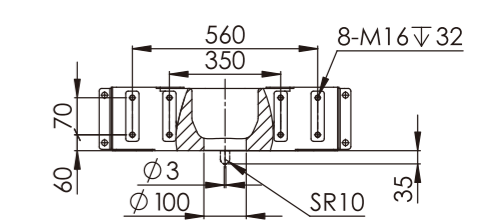
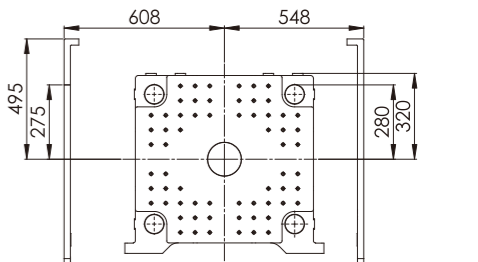

外形尺寸 Machine dimension

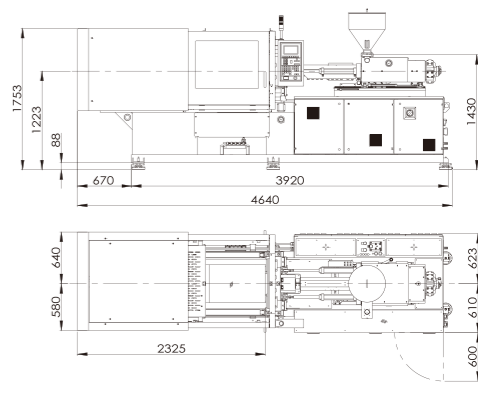

基于设计不断改良关系,规格如有更改,恕不另行通知。
Due to continual improvement, specifications are subject to change without prior notice.

MOTO-180

参数	PARAMETER	UNIT	A	B	C
国际公认型号	International Size Rating		640		
注射部分 INJECTION UNIT					
螺杆直径	Screw Diameter	mm	42	45	50
螺杆长径比	Screw L/D Ratio	L/D	22.5	21	18.9
理论注射容量	Injection volume(theoretical)	cm ³	305	350	432
注射重量 (PS)	Injection weight(PS)	g	277	318	393
注射速率	Injection rate	g/s	147	169	208
注射压力	Injection pressure	Mpa	206	179	145
螺杆转速	Screw speed	r/min	0-220		
合模部分 CLAMPING UNIT					
合模力	Clamping force	KN	1800		
移模行程	Mold opening stroke	mm	430		
拉杆间距	Space Between Tie Bars	mm	515x465		
最大模厚	Max.Mold Height	mm	580		
最小模厚	Min.Mold Height	mm	180		
顶出行程	Ejector stroke	mm	140		
顶出力	Ejector tonnage	KN	50		
其它 OTHERS					
油泵电机功率	Oil pump motor power	kw	18.7		
电热功率	Heater Power	kw	12.3		
外形尺寸	Machine dimension(LxWxH)	m	5.2x1.4x1.8		
机器重量	Machine weight	t	5.3		
料斗容积	Hopper capacity	kg	25		

机器尺寸 Machine dimensions

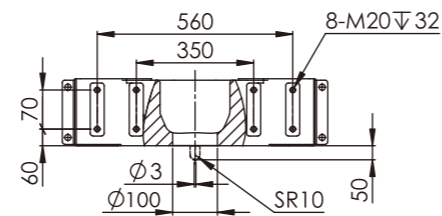
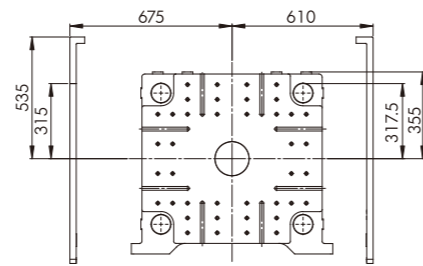
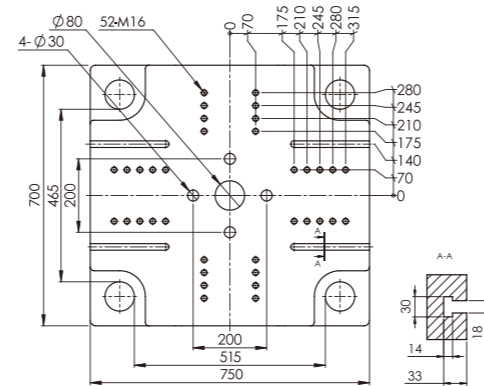

外形尺寸 Machine dimension

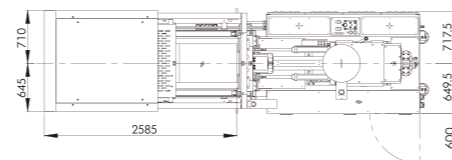
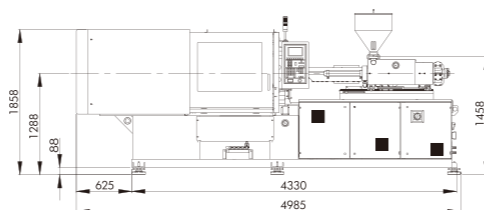

MOTO-220

参数	PARAMETER	UNIT	A	B	C
国际公认型号	International Size Rating		890		
注射部分 INJECTION UNIT					
螺杆直径	Screw Diameter	mm	45	50	55
螺杆长径比	Screw L/D Ratio	L/D	23.3	21	19
理论注射容量	Injection volume(theoretical)	cm ³	398	491	594
注射重量 (PS)	Injection weight(PS)	g	362	447	541
注射速率	Injection rate	g/s	133	165	200
注射压力	Injection pressure	Mpa	225	182	150
螺杆转速	Screw speed	r/min	0-170		
合模部分 CLAMPING UNIT					
合模力	Clamping force	KN	2200		
移模行程	Mold opening stroke	mm	490		
拉杆间距	Space Between Tie Bars	mm	575x525		
最大模厚	Max.Mold Height	mm	580		
最小模厚	Min.Mold Height	mm	200		
顶出行程	Ejector stroke	mm	150		
顶出力	Ejector tonnage	KN	70		
其它 OTHERS					
油泵电机功率	Oil pump motor power	kw	23		
电热功率	Heater Power	kw	14.4		
外形尺寸	Machine dimension(LxWxH)	m	5.9x1.6x2.0		
机器重量	Machine weight	t	7.5		
料斗容积	Hopper capacity	kg	50		

机器尺寸 Machine dimensions

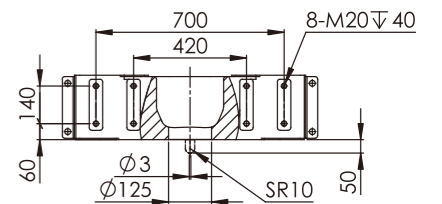
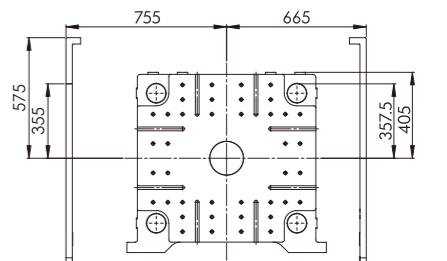
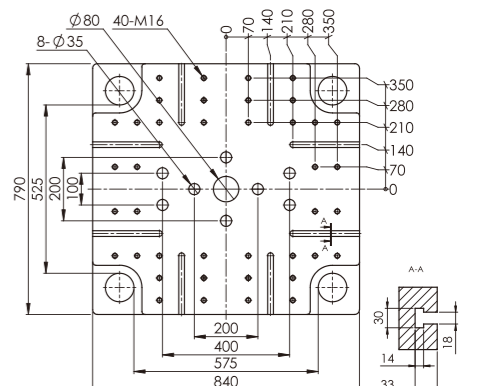

外形尺寸 Machine dimension

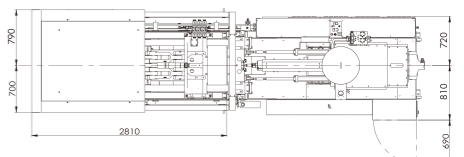
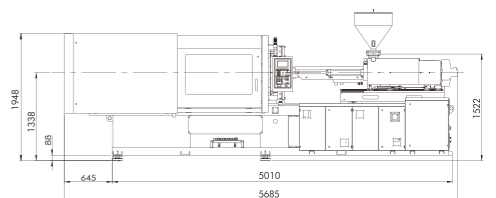

MOTO-250

参数	PARAMETER	UNIT	A	B	C
国际公认型号	International Size Rating		1098		
注射部分 INJECTION UNIT					
螺杆直径	Screw Diameter	mm	50	55	60
螺杆长径比	Screw L/D Ratio	L/D	24.8	22	19.7
理论注射容量	Injection volume(theoretical)	cm ³	432	552	687
注射重量 (PS)	Injection weight(PS)	g	393	502	625
注射速率	Injection rate	g/s	184	234	292
注射压力	Injection pressure	Mpa	254	199	160
螺杆转速	Screw speed	r/min	0-220		
合模部分 CLAMPING UNIT					
合模力	Clamping force	KN	2200		
移模行程	Mold opening stroke	mm	500		
拉杆间距	Space Between Tie Bars	mm	575x525		
最大模厚	Max.Mold Height	mm	580		
最小模厚	Min.Mold Height	mm	200		
顶出行程	Ejector stroke	mm	150		
顶出力	Ejector tonnage	KN	70		
其它 OTHERS					
油泵电机功率	Oil pump motor power	kw	27.8		
电热功率	Heater Power	kw	15.3		
外形尺寸	Machine dimension(LxWxH)	m	5.9x1.6x2.0		
机器重量	Machine weight	t	7.5		
料斗容积	Hopper capacity	kg	50		

机器尺寸 Machine dimensions

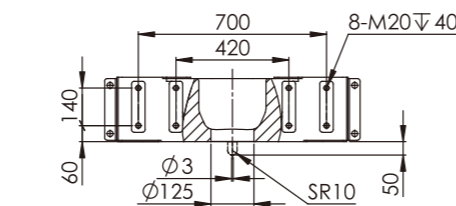
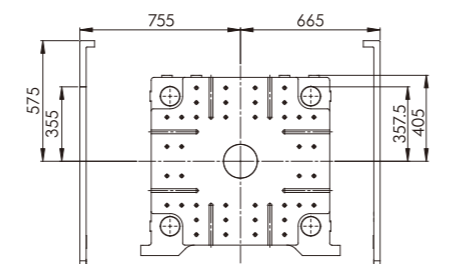
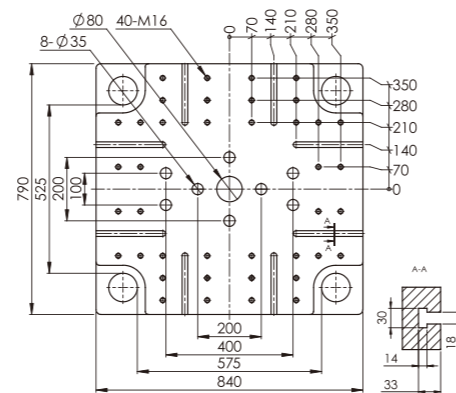

外形尺寸 Machine dimension

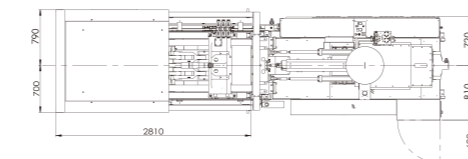
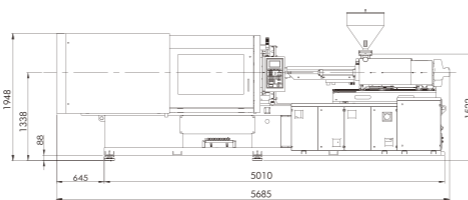

MOTO-280

参数	PARAMETER	UNIT	A	B	C
国际公认型号	International Size Rating		1560		
注射部分 INJECTION UNIT					
螺杆直径	Screw Diameter	mm	55	60	65
螺杆长径比	Screw L/D Ratio	L/D	22.9	21	19.4
理论注射容量	Injection volume(theoretical)	cm ³	713	848	995
注射重量 (PS)	Injection weight(PS)	g	649	772	906
注射速率	Injection rate	g/s	220	262	307
注射压力	Injection pressure	Mpa	219	184	156
螺杆转速	Screw speed	r/min	0-210		
合模部分 CLAMPING UNIT					
合模力	Clamping force	KN	2800		
移模行程	Mold opening stroke	mm	560		
拉杆间距	Space Between Tie Bars	mm	625x575		
最大模厚	Max.Mold Height	mm	600		
最小模厚	Min.Mold Height	mm	220		
顶出行程	Ejector stroke	mm	160		
顶出力	Ejector tonnage	KN	70		
其它 OTHERS					
油泵电机功率	Oil pump motor power	kw	36.5		
电热功率	Heater Power	kw	17.2		
外形尺寸	Machine dimension(LxWxH)	m	6.7x1.8x2.0		
机器重量	Machine weight	t	9.2		
料斗容积	Hopper capacity	kg	50		

机器尺寸 Machine dimensions

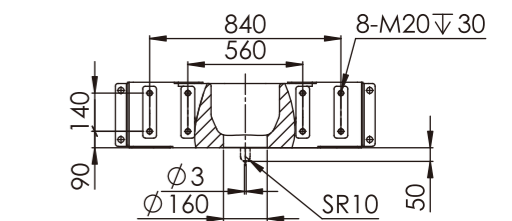
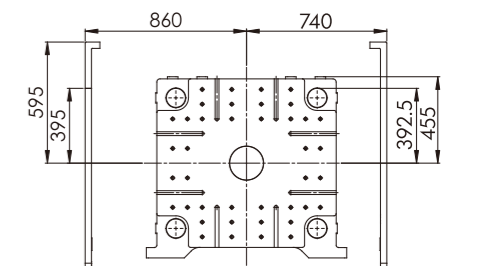
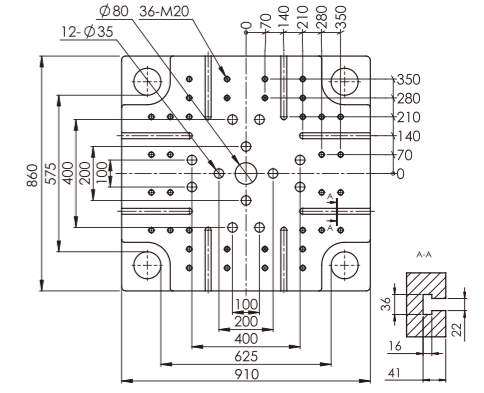

外形尺寸 Machine dimension

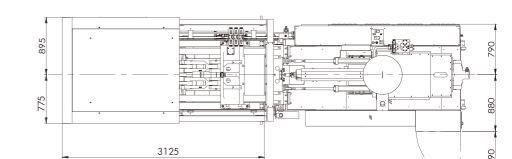
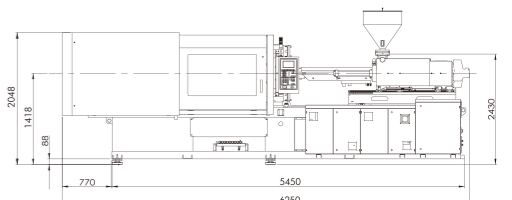

基于设计不断改良关系, 规格如有更改, 恕不另行通知。
Due to continual improvement, specifications are subject to change without prior notice.

MOTO-350

参数	PARAMETER	UNIT	A	B	C
国际公认型号	International Size Rating		2350		
注射部分 INJECTION UNIT					
螺杆直径	Screw Diameter	mm	65	70	75
螺杆长径比	Screw L/D Ratio	L/D	22.6	21	19.6
理论注射容量	Injection volume(theoretical)	cm ³	1161	1347	1546
注射重量 (PS)	Injection weight(PS)	g	1057	1226	1407
注射速率	Injection rate	g/s	298	345	397
注射压力	Injection pressure	Mpa	202	179	152
螺杆转速	Screw speed	r/min	0-180		
合模部分 CLAMPING UNIT					
合模力	Clamping force	KN	3500		
移模行程	Mold opening stroke	mm	670		
拉杆间距	Space Between Tie Bars	mm	730x680		
最大模厚	Max.Mold Height	mm	750		
最小模厚	Min.Mold Height	mm	280		
顶出行程	Ejector stroke	mm	180		
顶出力	Ejector tonnage	KN	120		
其它 OTHERS					
油泵电机功率	Oil pump motor power	kw	38.8		
电热功率	Heater Power	kw	20.3		
外形尺寸	Machine dimension(LxWxH)	m	7.7x2.0x2.1		
机器重量	Machine weight	t	13.1		
料斗容积	Hopper capacity	kg	50		

机器尺寸 Machine dimensions

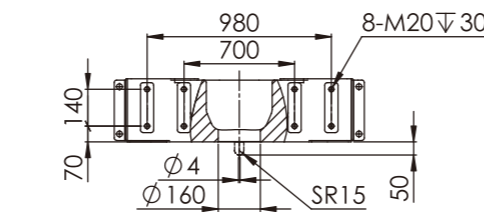
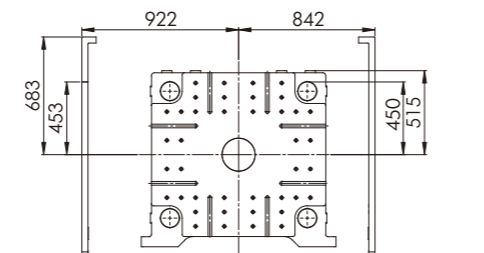
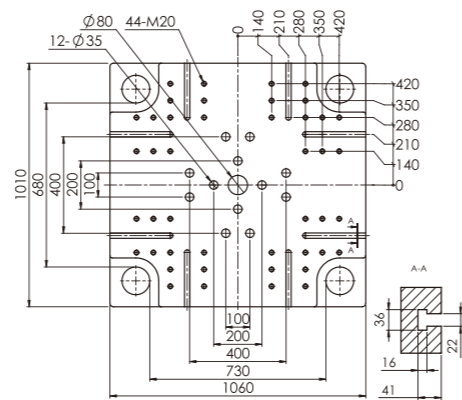

外形尺寸 Machine dimension

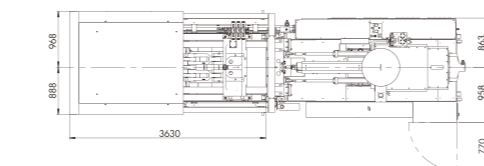
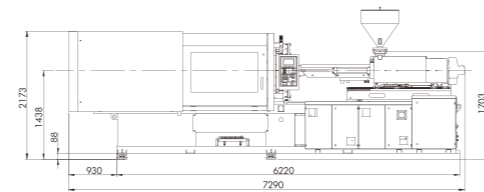

MOTO-450

参数	PARAMETER	UNIT	A	B	C
国际公认型号	International Size Rating		2980		
注射部分 INJECTION UNIT					
螺杆直径	Screw Diameter	mm	70	75	80
螺杆长径比	Screw L/D Ratio	L/D	22.5	21	19.7
理论注射容量	Injection volume(theoretical)	cm ³	1443	1657	1885
注射重量 (PS)	Injection weight(PS)	g	1313	1508	1715
注射速率	Injection rate	g/s	290	333	379
注射压力	Injection pressure	Mpa	206	179	158
螺杆转速	Screw speed	r/min	0-140		
合模部分 CLAMPING UNIT					
合模力	Clamping force	KN	4500		
移模行程	Mold opening stroke	mm	780		
拉杆间距	Space Between Tie Bars	mm	780x730		
最大模厚	Max.Mold Height	mm	800		
最小模厚	Min.Mold Height	mm	320		
顶出行程	Ejector stroke	mm	200		
顶出力	Ejector tonnage	KN	125		
其它 OTHERS					
油泵电机功率	Oil pump motor power	kw	50.2		
电热功率	Heater Power	kw	27.7		
外形尺寸	Machine dimension(LxWxH)	m	8.2x2.0x2.2		
机器重量	Machine weight	t	16.3		
料斗容积	Hopper capacity	kg	50		

机器尺寸 Machine dimensions

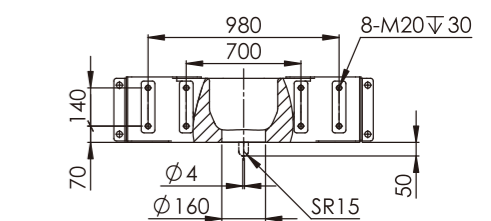
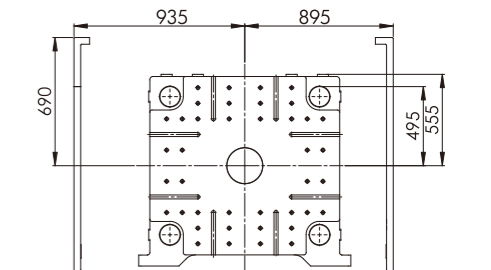
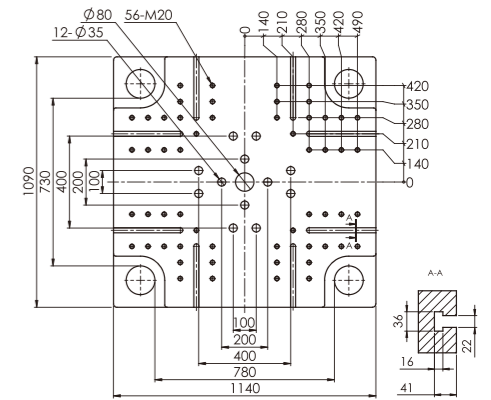

外形尺寸 Machine dimension

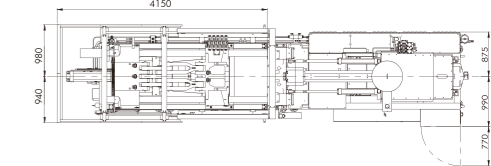
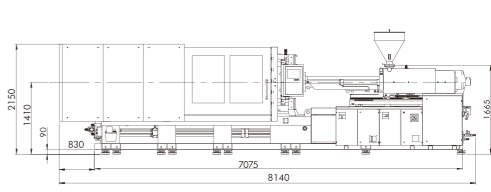

MOTO-550

参数	PARAMETER	UNIT	A	B	C
国际公认型号	International Size Rating		4250		
注射部分 INJECTION UNIT					
螺杆直径	Screw Diameter	mm	75	85	95
螺杆长径比	Screw L/D Ratio	L/D	23.8	21	18.8
理论注射容量	Injection volume(theoretical)	cm ³	1856	2383	2977
注射重量 (PS)	Injection weight(PS)	g	1689	2169	2709
注射速率	Injection rate	g/s	337	433	541
注射压力	Injection pressure	Mpa	229	178	142
螺杆转速	Screw speed	r/min	0-130		
合模部分 CLAMPING UNIT					
合模力	Clamping force	KN	5500		
移模行程	Mold opening stroke	mm	900		
拉杆间距	Space Between Tie Bars	mm	880x820		
最大模厚	Max.Mold Height	mm	850		
最小模厚	Min.Mold Height	mm	350		
顶出行程	Ejector stroke	mm	250		
顶出力	Ejector tonnage	KN	160		
其它 OTHERS					
油泵电机功率	Oil pump motor power	kw	50.2		
电热功率	Heater Power	kw	38.3		
外形尺寸	Machine dimension(LxWxH)	m	9.1x2.2x2.2		
机器重量	Machine weight	t	22		
料斗容积	Hopper capacity	kg	50		

机器尺寸 Machine dimensions

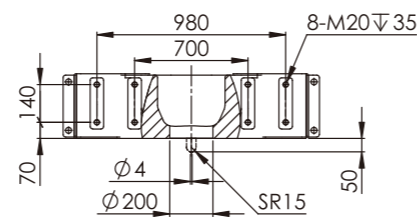
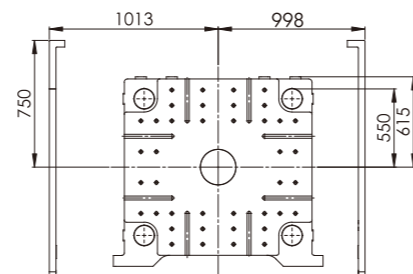
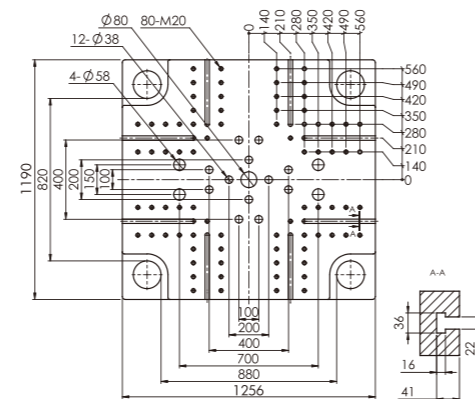

外形尺寸 Machine dimension

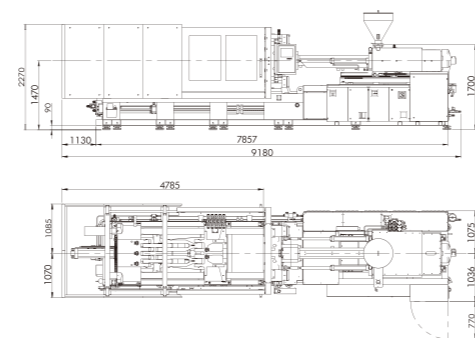

MOTO-650

参数	PARAMETER	UNIT	A	B	C	D
国际公认型号	International Size Rating		5060			
注射部分 INJECTION UNIT						
螺杆直径	Screw Diameter	mm	80	90	100	110
螺杆长径比	Screw L/D Ratio	L/D	26.3	23.3	21	21
理论注射容量	Injection volume(theoretical)	cm ³	2262	2863	3534	4276
注射重量 (PS)	Injection weight(PS)	g	2058	2605	3216	3891
注射速率	Injection rate	g/s	390	493	609	737
注射压力	Injection pressure	Mpa	224	177	143	118
螺杆转速	Screw speed	r/min	0-134			
合模部分 CLAMPING UNIT						
合模力	Clamping force	KN	6500			
移模行程	Mold opening stroke	mm	960			
拉杆间距	Space Between Tie Bars	mm	930x880			
最大模厚	Max.Mold Height	mm	950			
最小模厚	Min.Mold Height	mm	380			
顶出行程	Ejector stroke	mm	260			
顶出力	Ejector tonnage	KN	200			
其它 OTHERS						
油泵电机功率	Oil pump motor power	kw	36.5+36.5			
电热功率	Heater Power	kw	42.			
外形尺寸	Machine dimension(LxWxH)	m	9.8x2.5x2.5			
机器重量	Machine weight	t	28			
料斗容积	Hopper capacity	kg	100			

机器尺寸 Machine dimensions

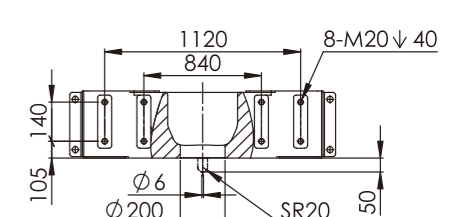
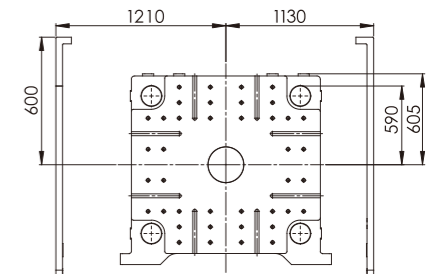
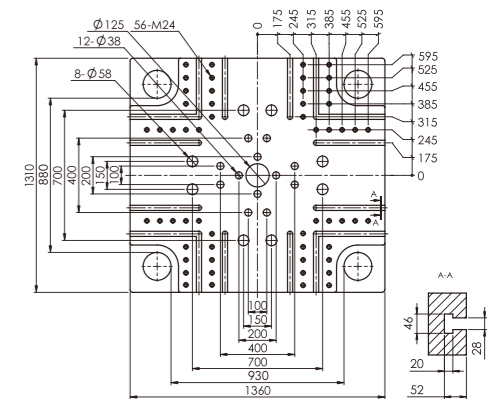

外形尺寸 Machine dimension

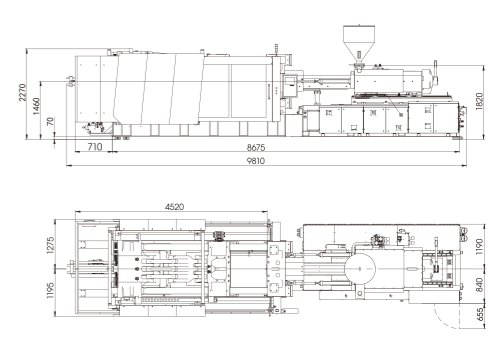

MOTO-750

参数	PARAMETER	UNIT	A	B	C	D
国际公认型号	International Size Rating		6000			
注射部分 INJECTION UNIT						
螺杆直径	Screw Diameter	mm	85	95	105	115
螺杆长径比	Screw L/D Ratio	L/D	24.3	21.8	21	21
理论注射容量	Injection volume(theoretical)	cm ³	2554	3190	3897	4674
注射重量 (PS)	Injection weight(PS)	g	2324	2903	3546	4253
注射速率	Injection rate	g/s	427	534	652	783
注射压力	Injection pressure	Mpa	232	186	152	1270
螺杆转速	Screw speed	r/min	0-115			
合模部分 CLAMPING UNIT						
合模力	Clamping force	KN	7500			
移模行程	Mold opening stroke	mm	1000			
拉杆间距	Space Between Tie Bars	mm	980x960			
最大模厚	Max.Mold Height	mm	1000			
最小模厚	Min.Mold Height	mm	400			
顶出行程	Ejector stroke	mm	280			
顶出力	Ejector tonnage	KN	200			
其它 OTHERS						
油泵电机功率	Oil pump motor power	kw	36.5+38.8			
电热功率	Heater Power	kw	54.3			
外形尺寸	Machine dimension(LxWxH)	m	10.5x2.6x2.4			
机器重量	Machine weight	t	33			
料斗容积	Hopper capacity	kg	100			

机器尺寸 Machine dimensions

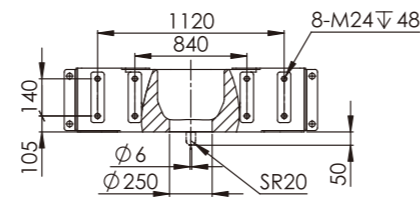
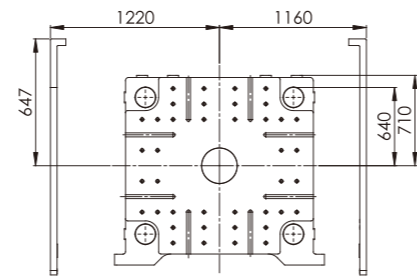
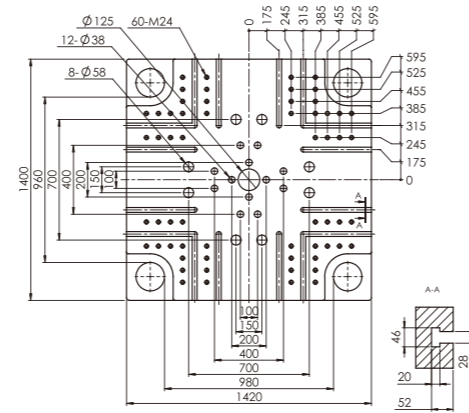

外形尺寸 Machine dimension

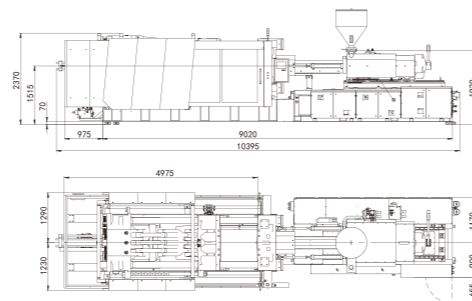

MOTO-950

参数	PARAMETER	UNIT	A	B	C	D
国际公认型号	International Size Rating		7100			
注射部分 INJECTION UNIT						
螺杆直径	Screw Diameter	mm	90	100	110	120
螺杆长径比	Screw L/D Ratio	L/D	25	23	21	21
理论注射容量	Injection volume(theoretical)	cm ³	3117	3848	4657	5542
注射重量 (PS)	Injection weight(PS)	g	2836	3502	4238	5043
注射速率	Injection rate	g/s	533	658	796	947
注射压力	Injection pressure	Mpa	227	184	152	128
螺杆转速	Screw speed	r/min	0-111			
合模部分 CLAMPING UNIT						
合模力	Clamping force	KN	9500			
移模行程	Mold opening stroke	mm	1130			
拉杆间距	Space Between Tie Bars	mm	1130x1080			
最大模厚	Max.Mold Height	mm	1100			
最小模厚	Min.Mold Height	mm	450			
顶出行程	Ejector stroke	mm	320			
顶出力	Ejector tonnage	KN	215			
其它 OTHERS						
油泵电机功率	Oil pump motor power	kw	38.8+38.8			
电热功率	Heater Power	kw	56.6			
外形尺寸	Machine dimension(LxWxH)	m	11.2x2.7x2.5			
机器重量	Machine weight	t	48			
料斗容积	Hopper capacity	kg	100			

机器尺寸 Machine dimensions

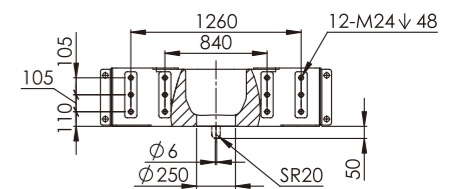
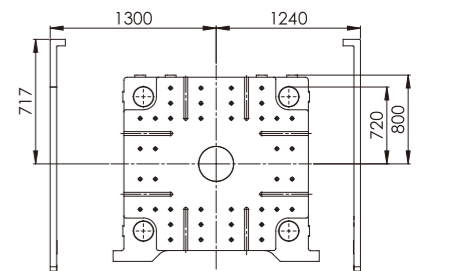
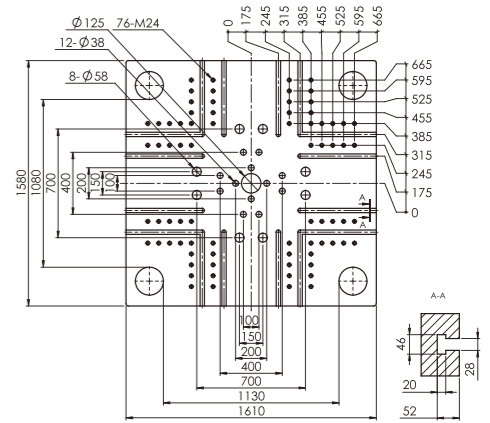

外形尺寸 Machine dimension

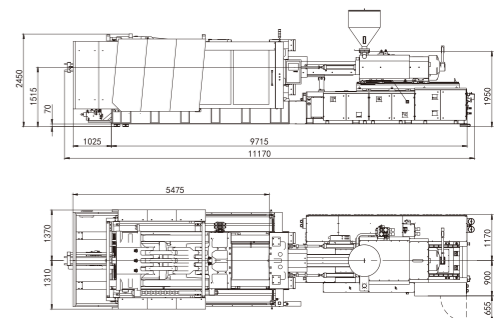

MOTO-1150

参数	PARAMETER	UNIT	A	B	C	D
国际公认型号	International Size Rating		8900			
注射部分 INJECTION UNIT						
螺杆直径	Screw Diameter	mm	100	110	120	130
螺杆长径比	Screw L/D Ratio	L/D	25	23	21	21
理论注射容量	Injection volume(theoretical)	cm ³	4163	5037	5994	7035
注射重量 (PS)	Injection weight(PS)	g	3788	4584	5455	6402
注射速率	Injection rate	g/s	601	728	866	1016
注射压力	Injection pressure	Mpa	212	175	147	125
螺杆转速	Screw speed	r/min	0-99			
合模部分 CLAMPING UNIT						
合模力	Clamping force	KN	11500			
移模行程	Mold opening stroke	mm	1230			
拉杆间距	Space Between Tie Bars	mm	1230x1180			
最大模厚	Max.Mold Height	mm	1200			
最小模厚	Min.Mold Height	mm	500			
顶出行程	Ejector stroke	mm	320			
顶出力	Ejector tonnage	KN	215			
其它 OTHERS						
油泵电机功率	Oil pump motor power	kw	50.2+50.2			
电热功率	Heater Power	kw	70			
外形尺寸	Machine dimension(LxWxH)	m	12.2x2.8x2.7			
机器重量	Machine weight	t	55			
料斗容积	Hopper capacity	kg	100			

机器尺寸 Machine dimensions

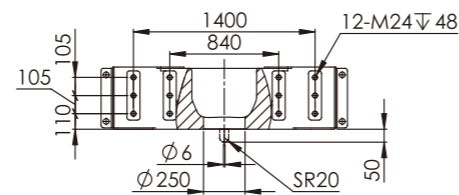
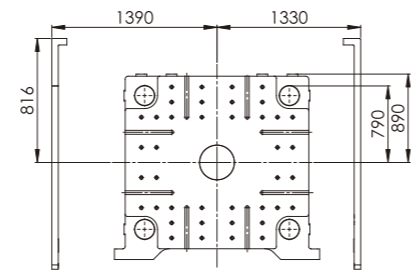
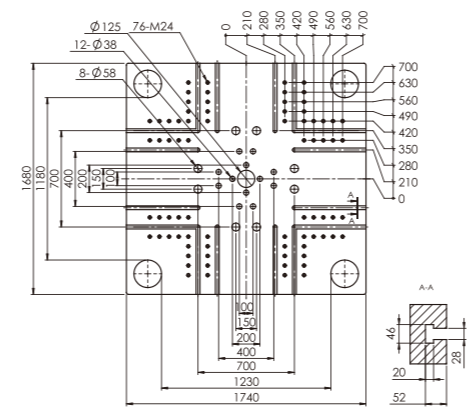

外形尺寸 Machine dimension

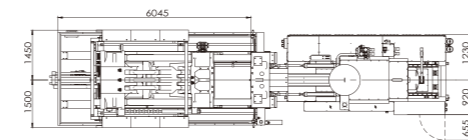
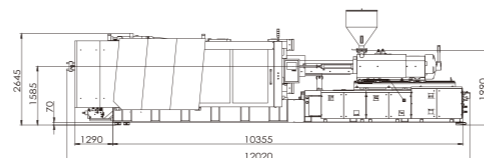

MOTO-1350

参数	PARAMETER	UNIT	A	B	C	D
国际公认型号	International Size Rating		12500			
注射部分 INJECTION UNIT						
螺杆直径	Screw Diameter	mm	110	120	130	140
螺杆长径比	Screw L/D Ratio	L/D	26	24	22	22
理论注射容量	Injection volume(theoretical)	cm ³	5702	6786	7964	9236
注射重量 (PS)	Injection weight(PS)	g	5189	6175	7247	8405
注射速率	Injection rate	g/s	740	880	1033	1199
注射压力	Injection pressure	Mpa	215	180	154	132
螺杆转速	Screw speed	r/min	0-104			
合模部分 CLAMPING UNIT						
合模力	Clamping force	KN	13500			
移模行程	Mold opening stroke	mm	1420			
拉杆间距	Space Between Tie Bars	mm	1380x1280			
最大模厚	Max.Mold Height	mm	1350			
最小模厚	Min.Mold Height	mm	600			
顶出行程	Ejector stroke	mm	350			
顶出力	Ejector tonnage	KN	215			
其它 OTHERS						
油泵电机功率	Oil pump motor power	kw	34+34+34			
电热功率	Heater Power	kw	91.5			
外形尺寸	Machine dimension(LxWxH)	m	13.2x3.1x3.3			
机器重量	Machine weight	t	73			
料斗容积	Hopper capacity	kg	100			

机器尺寸 Machine dimensions

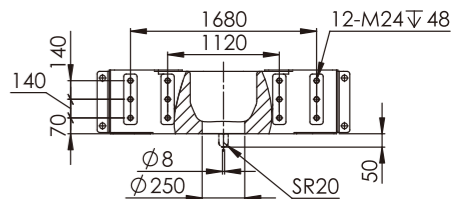
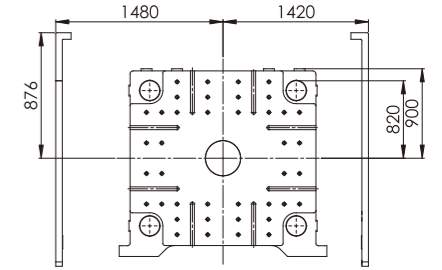
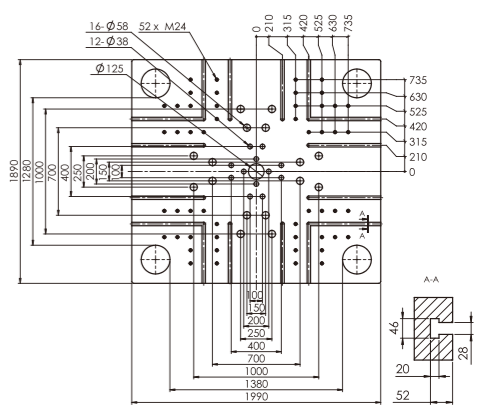

外形尺寸 Machine dimension

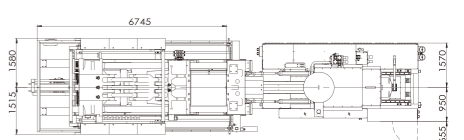
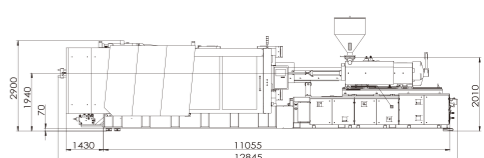

MOTO-1700

参数	PARAMETER	UNIT	A	B	C	D
国际公认型号	International Size Rating		15069			
注射部分 INJECTION UNIT						
螺杆直径	Screw Diameter	mm	120	130	140	150
螺杆长径比	Screw L/D Ratio	L/D	23.3	22.6	20	18.7
理论注射容量	Injection volume(theoretical)	cm ³	7351	8628	10006	11486
注射重量 (PS)	Injection weight(PS)	g	6690	7851	9105	10453
注射速率	Injection rate	g/s	1070	1256	1457	1672
注射压力	Injection pressure	Mpa	205	174	150	131
螺杆转速	Screw speed	r/min	0-85			
合模部分 CLAMPING UNIT						
合模力	Clamping force	KN	17000			
移模行程	Mold opening stroke	mm	1700			
拉杆间距	Space Between Tie Bars	mm	1560x1430			
最大模厚	Max.Mold Height	mm	1600			
最小模厚	Min.Mold Height	mm	700			
顶出行程	Ejector stroke	mm	400			
顶出力	Ejector tonnage	KN	330			
其它 OTHERS						
油泵电机功率	Oil pump motor power	kw				
电热功率	Heater Power	kw	98.1			
外形尺寸	Machine dimension(LxWxH)	m	16.0x3.2x3.6			
机器重量	Machine weight	t	103			
料斗容积	Hopper capacity	kg				

机器尺寸 Machine dimensions

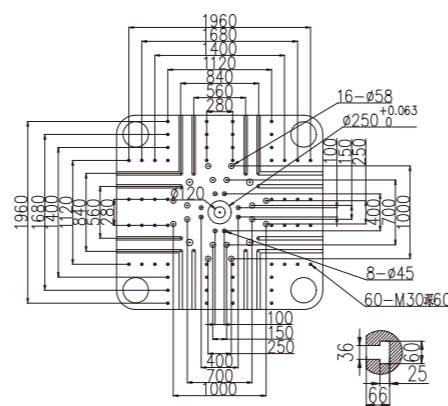

外形尺寸 Machine dimension

MOTO-2200

参数	PARAMETER	UNIT	A	B	C	D
国际公认型号	International Size Rating		7100			
注射部分 INJECTION UNIT						
螺杆直径	Screw Diameter	mm	130	140	150	160
螺杆长径比	Screw L/D Ratio	L/D	25.9	24	22.4	20.9
理论注射容量	Injection volume(theoretical)	cm ³	9680	11230	12890	14670
注射重量 (PS)	Injection weight(PS)	g	8808	10219	11730	13350
注射速率	Injection rate	g/s	1172	1360	1560	1776
注射压力	Injection pressure	Mpa	184	159	138	122
螺杆转速	Screw speed	r/min	70			
合模部分 CLAMPING UNIT						
合模力	Clamping force	KN	22000			
移模行程	Mold opening stroke	mm	1810			
拉杆间距	Space Between Tie Bars	mm	1750x1600			
最大模厚	Max.Mold Height	mm	1700			
最小模厚	Min.Mold Height	mm	750			
顶出行程	Ejector stroke	mm	420			
顶出力	Ejector tonnage	KN	490			
其它 OTHERS						
油泵电机功率	Oil pump motor power	kw	55+55+55			
电热功率	Heater Power	kw	114.5			
外形尺寸	Machine dimension(LxWxH)	m	21.3x3.4x4.3			
机器重量	Machine weight	t	137			
料斗容积	Hopper capacity	kg				

机器尺寸 Machine dimensions

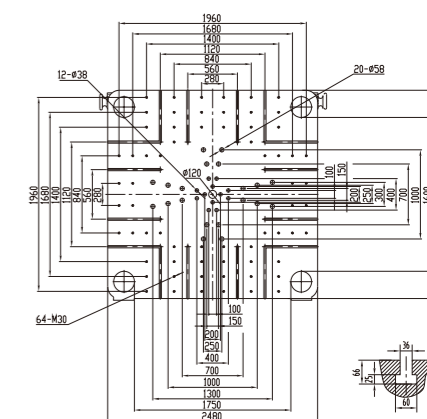

外形尺寸 Machine dimension

MOTO-2500

参数	PARAMETER	UNIT	A	B	C	D	
国际公认型号	International Size Rating		8900				
注射部分 INJECTION UNIT							
螺杆直径	Screw Diameter	mm	150	160	170		
螺杆长径比	Screw L/D Ratio	L/D	22.4	21	19.8		
理论注射容量	Injection volume(theoretical)	cm ³	14136	16084	18149		
注射重量 (PS)	Injection weight(PS)	g	12864	14636	16515		
注射速率	Injection rate	g/s	1191	1355	1529		
注射压力	Injection pressure	Mpa	192	169	149		
螺杆转速	Screw speed	r/min				0-86	
合模部分 CLAMPING UNIT							
合模力	Clamping force	KN					25000
移模行程	Mold opening stroke	mm					1810
拉杆间距	Space Between Tie Bars	mm					1850×1700
最大模厚	Max.Mold Height	mm					1800
最小模厚	Min.Mold Height	mm					800
顶出行程	Ejector stroke	mm					450
顶出力	Ejector tonnage	KN					430
其它 OTHERS							
油泵电机功率	Oil pump motor power	kw					45+45+45+45
电热功率	Heater Power	kw					133.7
外形尺寸	Machine dimension(LxWxH)	m					19.3×3.8×4.7
机器重量	Machine weight	t					140
料斗容积	Hopper capacity	kg					

机器尺寸 Machine dimensions

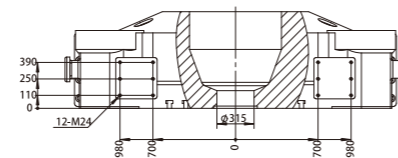
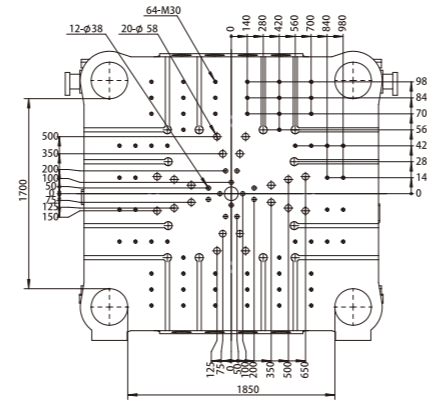

外形尺寸 Machine dimension



快速注塑成型机
Rapid injection molding machine



高速注塑成型机
High speed injection molding machine



PET瓶胚注塑成型机
PET preform injection molding machine

