

34SH 系列中压空气压缩机

34SH SERIES MIDDLE PRESSURE AIR COMPRESSOR

零部件手册

PARTS LIST

南京尚爱机电有限公司

Nanjing Shangair Mechanical & Electrical Co., Ltd.

Content

Figure A: outline drawing & list of 34SH horizontal single-engine unit	2
Figure B: outline drawing & list of 34SH vertical single-engine unit	4
Figure C: outline drawing & list of 34SH vertical double-engine unit	6
Figure D: outline drawing & list of 34SH horizontal double-engine unit(back to back).....	7
Figure E: outline drawing & list of 34SH vertical three-engine unit.....	8
Figure F: outline drawing & list of 34SH vertical four-engine unit.....	9
Figure G: outline drawing & list of 34SH main engine.....	10
Drawing 1: crankcase components & list	11
Drawing 2: first-stage cylinder piston conrod parts	13
Drawing 3: second-stage cylinder piston conrod parts.....	15
Drawing 4: third-stage cylinder piston conrod parts	17
Drawing 5:intercooler.....	19
Drawing 6: circuit diagram of 34SH single-engine unit	20
Table 7: full set of gasket list of 34SH machine head.....	21

Figure A: Outline Drawing of 34SH Horizontal Single-Engine Unit

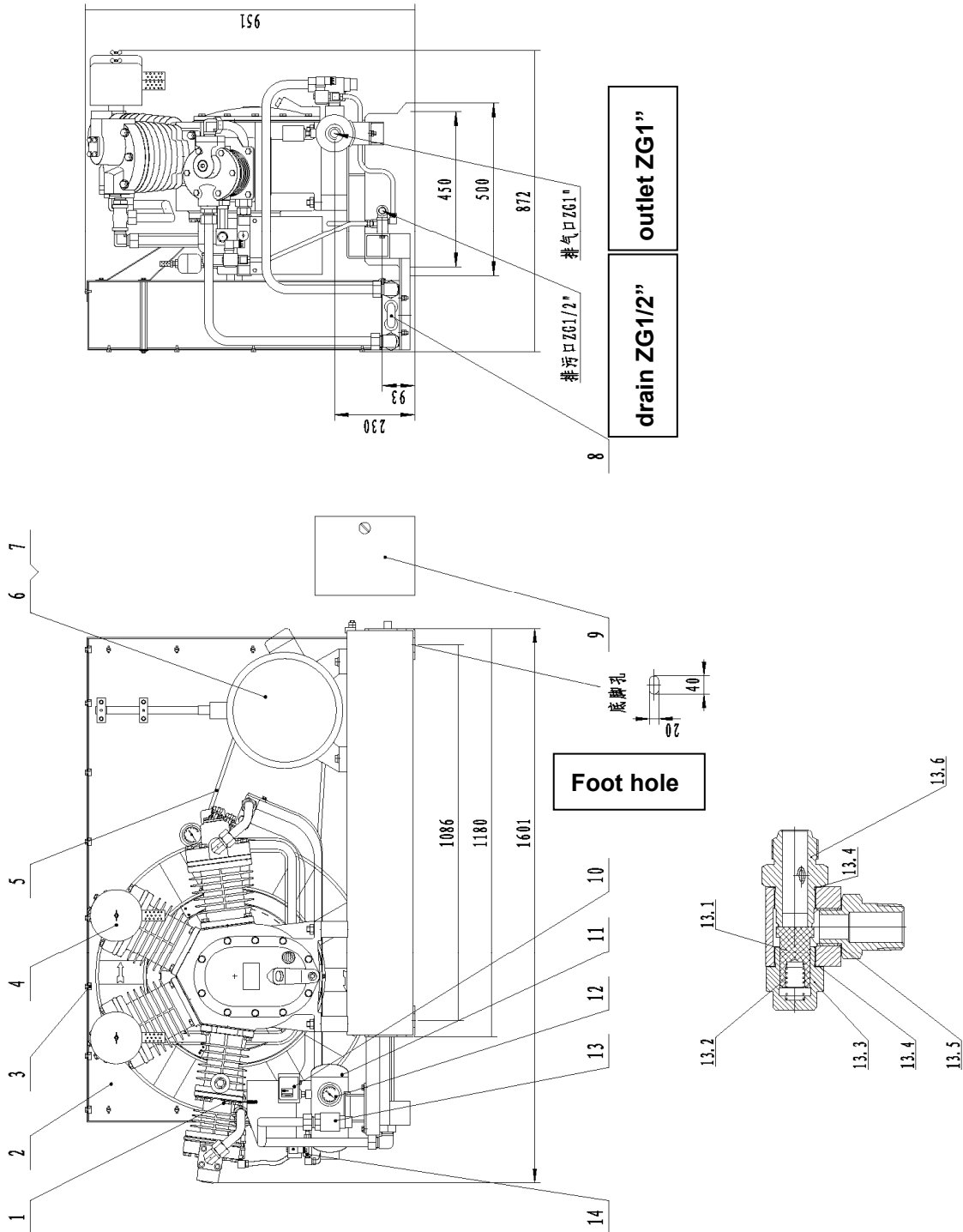

S/N	Specification & Code	Name	Qty	Remarks
A-01	34.SH.00.00	34SH machine head	1	
A-02	83.1H.00.01	Protection net 1450*850*200	1	
A-03	Protective net locking clasp	Locking clasp	13	
A-04	Suction muffler G11/4"	Suction muffler	2	
A-04.1	Suction muffler filter core	filter core	2	
A-05	Triangle belt B2464	Triangle belt	4	
A-06	Y160L-4-15	Motor	1	
A-06	Y180M-4-18.5	Motor	1	
A-07	PD.01.00.02	Belt wheel 232*670	1	15KW
A-07	PD.03.00.06	Belt wheel 253*730	1	18.5KW
A-08	09.SH.1H.03	aftercooler	1	
A-09	DQ.11.00.00	Electric cabinet	1	standard
A-10	KP58-32Bar	Pressure switch	1	
A-11	YQ.33.01.00	Gas collector	1	
A-12	YZ60-6.0/M14	Pressure gauge	1	
A-13	RD.05.0A.00	Stainless steel Vessel check valve	1	
A-13.1	RD.05.0A.A5	Check valve core	1	
A-13.2	RD.01.00.04	Spring	1	
A-13.3	RD.05.0A.04	Stainless steel guide body	1	
A-13.4	RD.05.00.09	Copper pad	1	
A-13.5	RD.05.00.10	Copper pad	1	
A-13.6	RD.05.0A.01	Stainless steel valve body	1	
A-14	8.0Mpa(1/4NPT-220V)	Solenoid valve	1	

Figure B: Outline Drawing of 34SH Vertical Single-Engine Unit

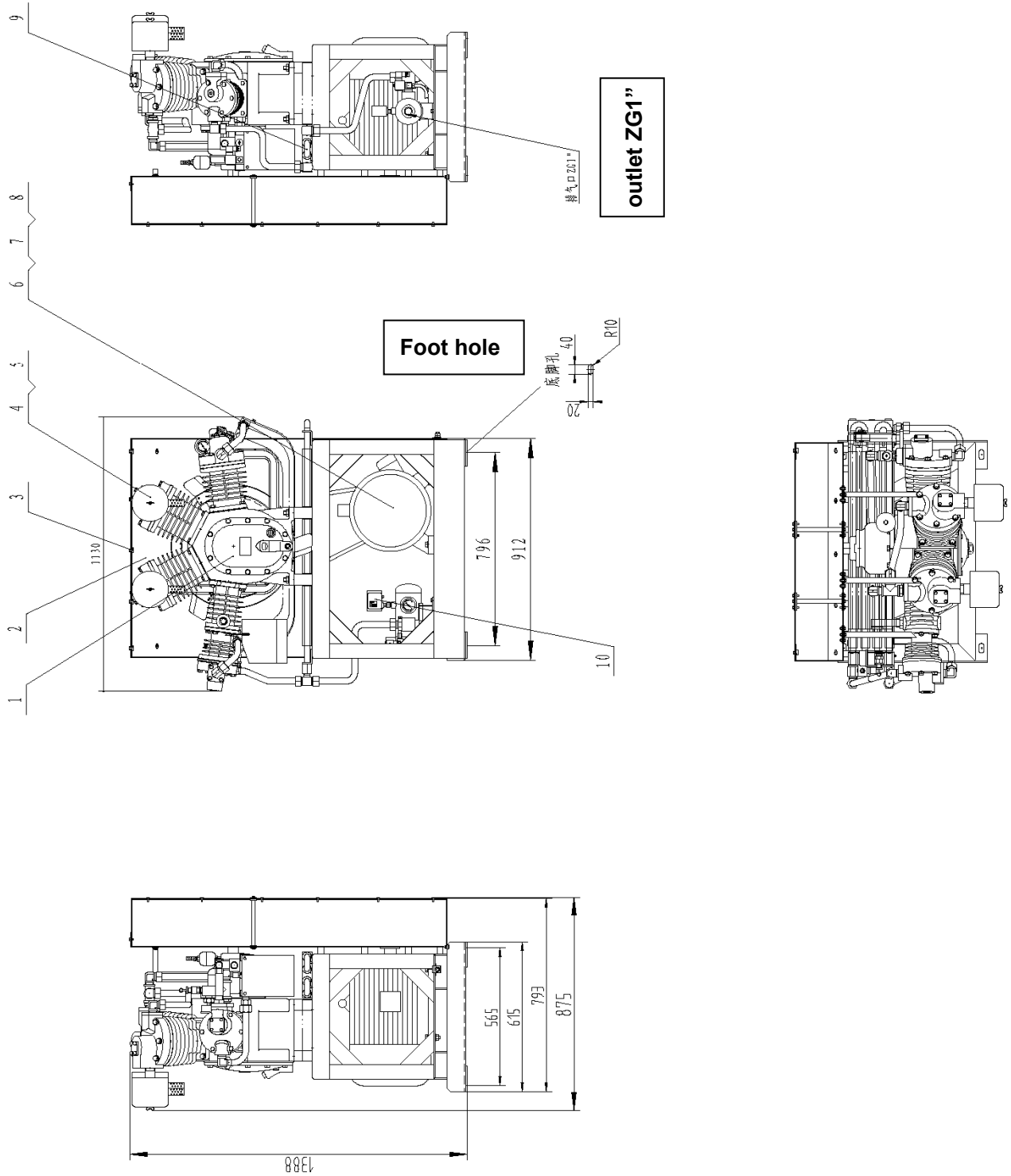

S/N	Specification & Code	Name	Qty	Remarks
B-01	34.SH.00.00	34SH machine head	1	
B-02	34.11.03.00	Protection net 1300*900*200	1	
B-03	Protective net locking clasp	Locking clasp	13	
B-04	Suction muffler G11/4"	Suction muffler	2	
B-05	Suction muffler filter core	filter core	2	
B-06	Triangle belt B2464	Triangle belt	4	
B-07	Y160L-4-15	Motor	1	
B-07	Y180M-4-18.5	Motor	1	
B-08	PD.01.00.02	Belt wheel 232*670	1	15KW
B-08	PD.03.00.06	Belt wheel 253*730	1	18.5KW
B-09	09.SH.1T.01	Aftercooler	1	
B-10	KP58-32Bar	Pressure switch	1	

Figure C: Outline Drawing of 34SH Vertical Double-Engine Unit

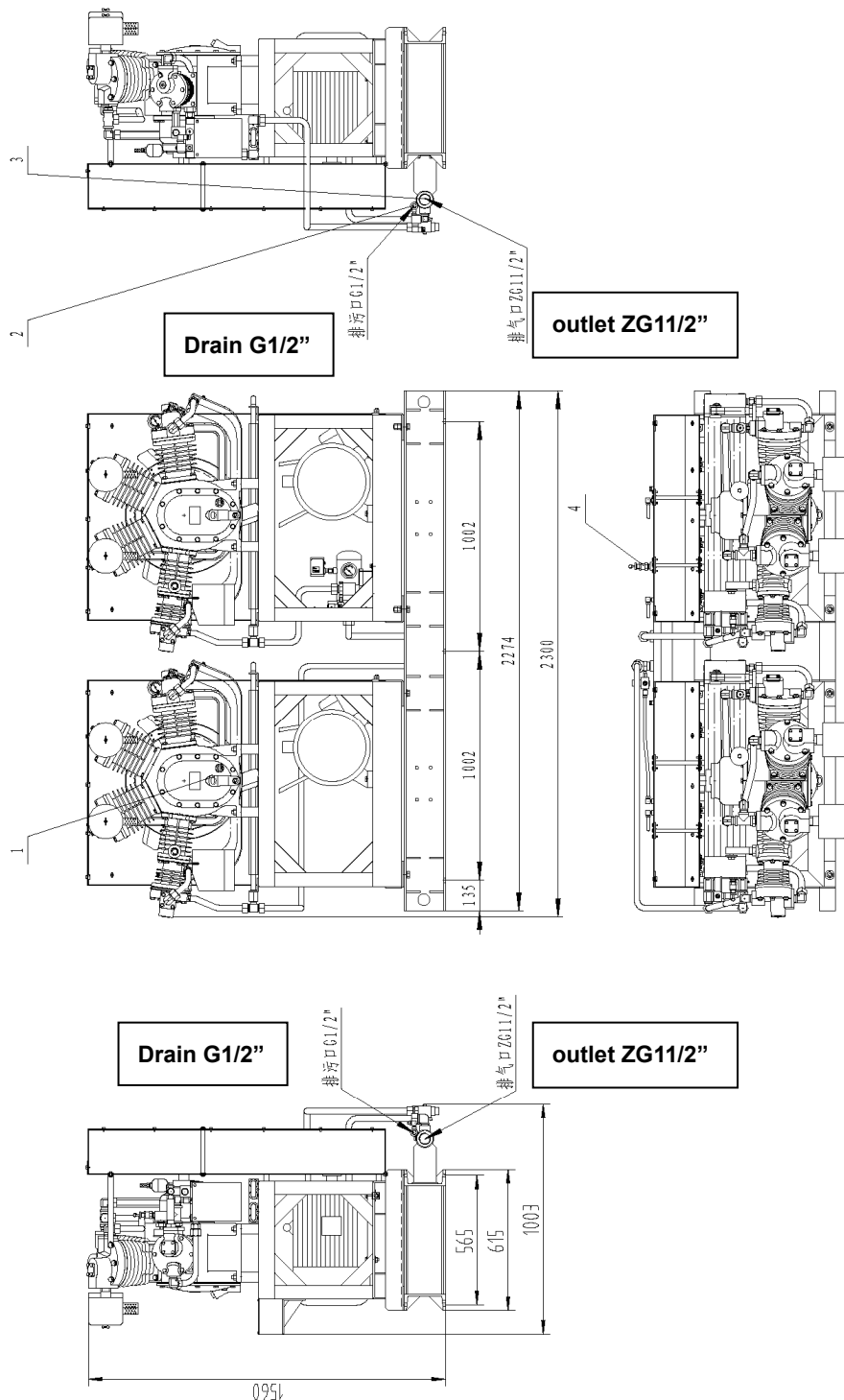

1、34SH single unit 2、drain pipe 3、outlet pipe 4、safety valve

S/N	Specification & Code	Name	Qty	Remarks
C-4	AQ.01.30.33	Safety valve	1	3.3MPa-ZG1/2"

Figure D: Outline Drawing of 34SH Horizontal Double-Engine Unit

(back to back)

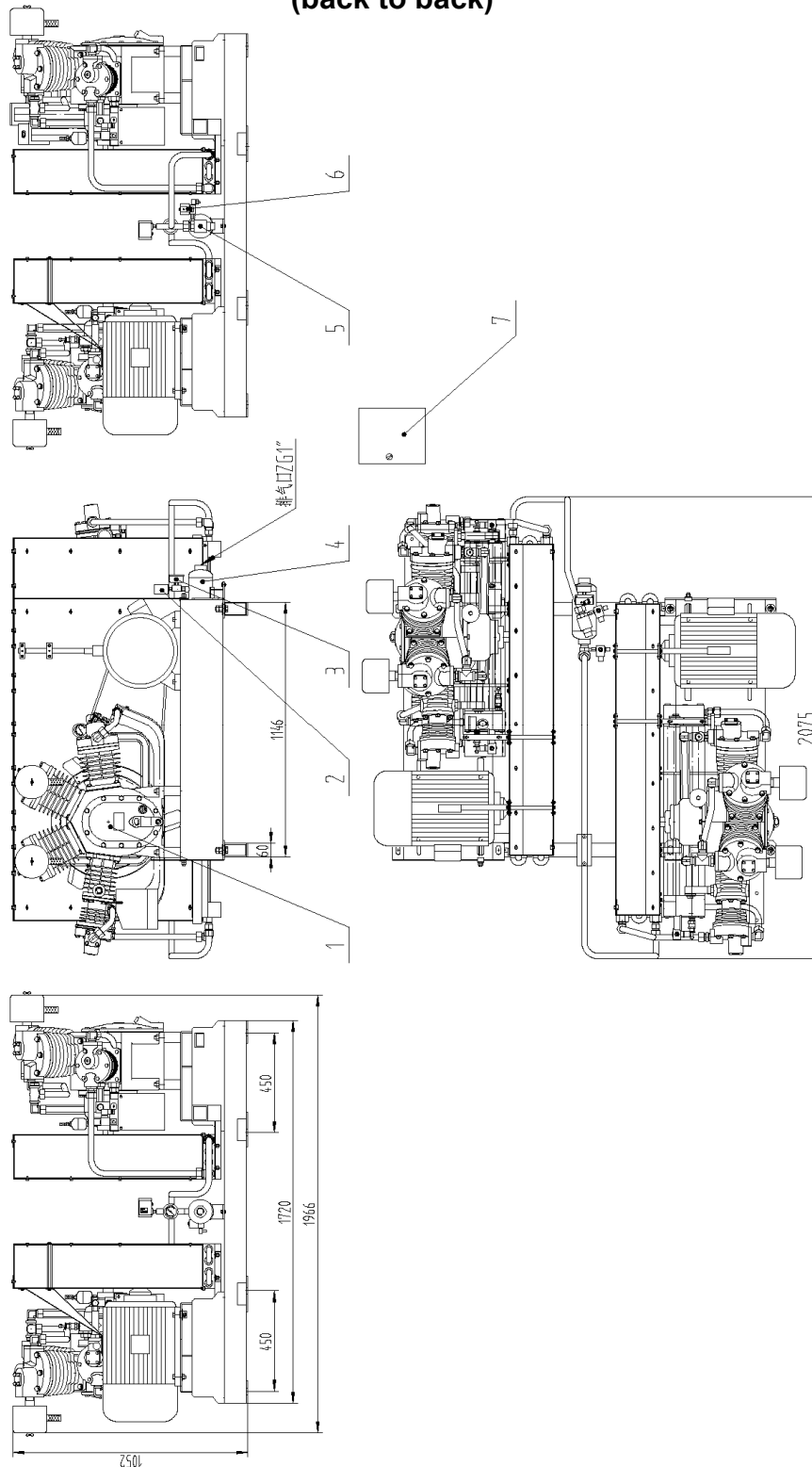

- 1、 34SH horizontal single unit 2、 pressure switch 3、 manometer 4、 gas collector
5、 check valve 6、 solenoid valve 7. electric cabinet

Figure E: Outline Drawing of 34SH Vertical Three-Engine Unit

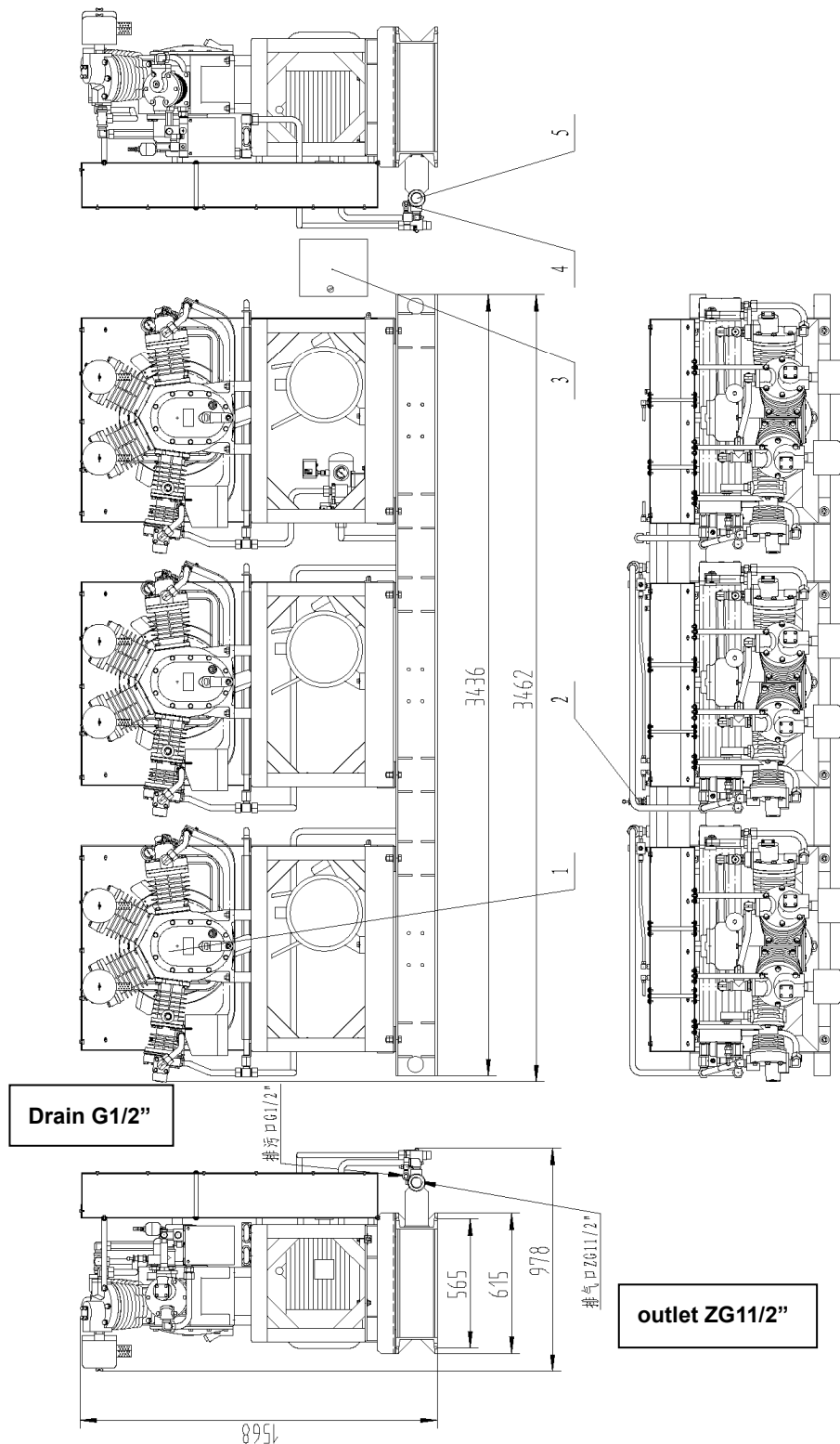

- 1、 34SH vertical single unit 2、 safety valve 3、 electric cabinet
4、 check valve 5、 solenoid valve

Figure F: Outline Drawing of 34SH Vertical Four-Engine Unit

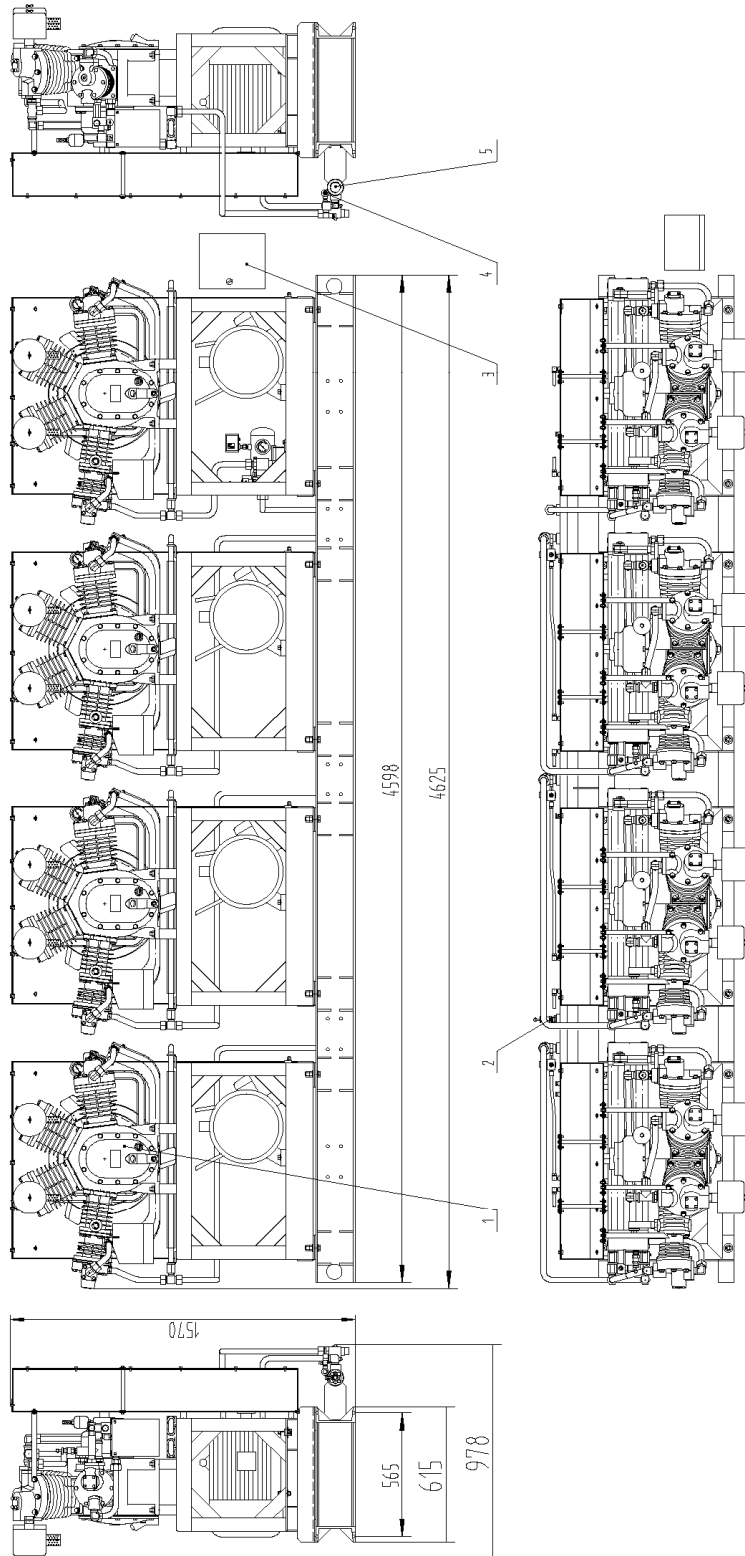

- 1、 34SH vertical single unit 2、 safety valve 3、 electric cabinet
4、 check valve 5、 solenoid valve

Figure G: Outline Drawing of 34SH Main Engine

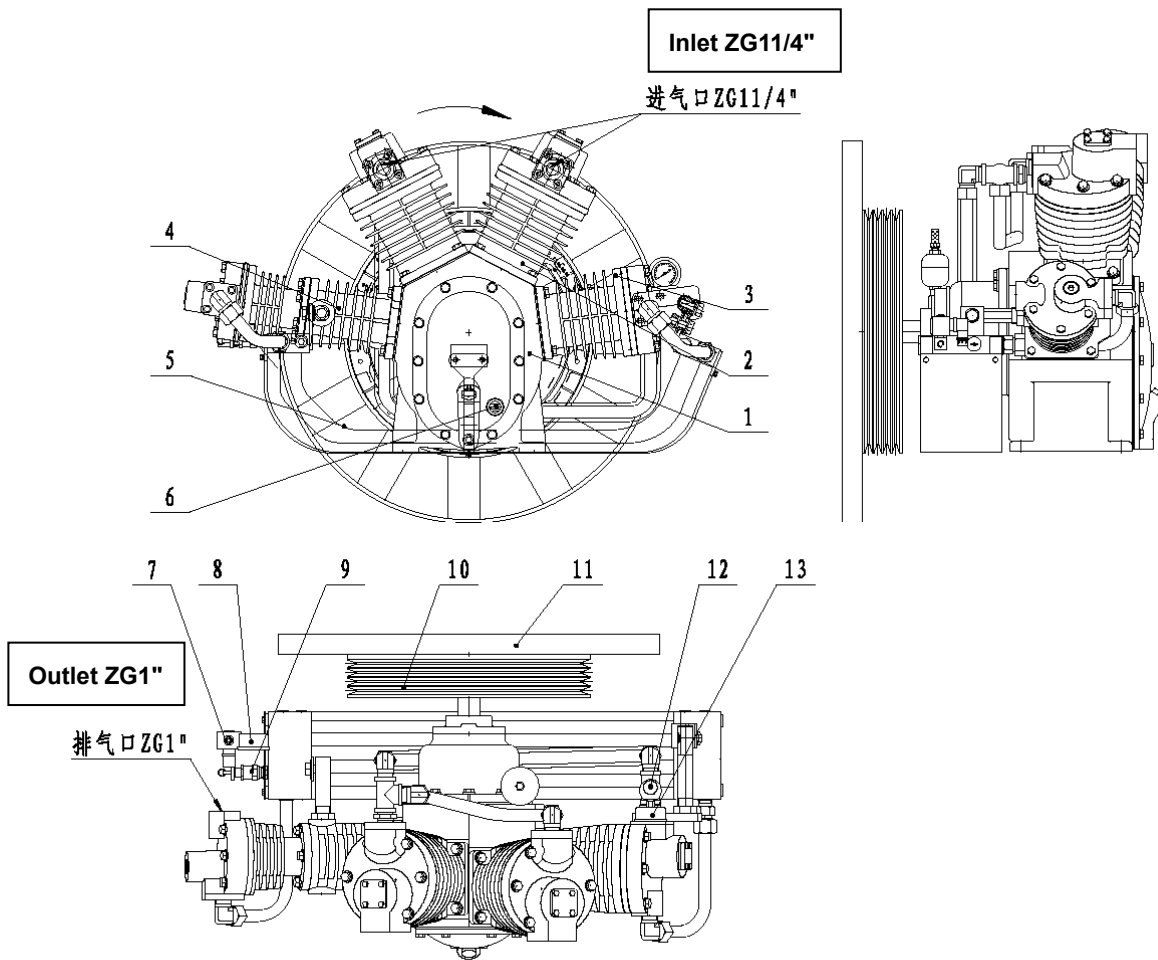

S/N	Specification & Code	Name	Qty	Remarks
G-01	drawing 1	Crankcase parts	1	
G-02	drawing 2	First-stage cylinder piston parts	2	
G-03	drawing 3	second-stage cylinder piston parts	1	
G-04	drawing 4	third-stage cylinder piston parts	1	
G-05	drawing 5	intercooler	1	
G-06	Special grade synthetic oil	Lubricant	4.8L	
G-07	8.0Mpa(1/4NPT-220V)	Solenoid valve	1	
G-08	Y60-6.0/M14	2 nd stage manometer	1	
G-09	AQ.05.10.10	Safety valve	1	
G-10	09.SH.00.10	Fan wheel	1	
G-11	83.00.00.09	Fan wheel	1	
G-12	AQ.06.04.04	Safety valve	1	
G-13	YZ60-1.0/M14	1 st stage manometer	1	

Breakdown Drawing 1: Crankcase Components (1 set)

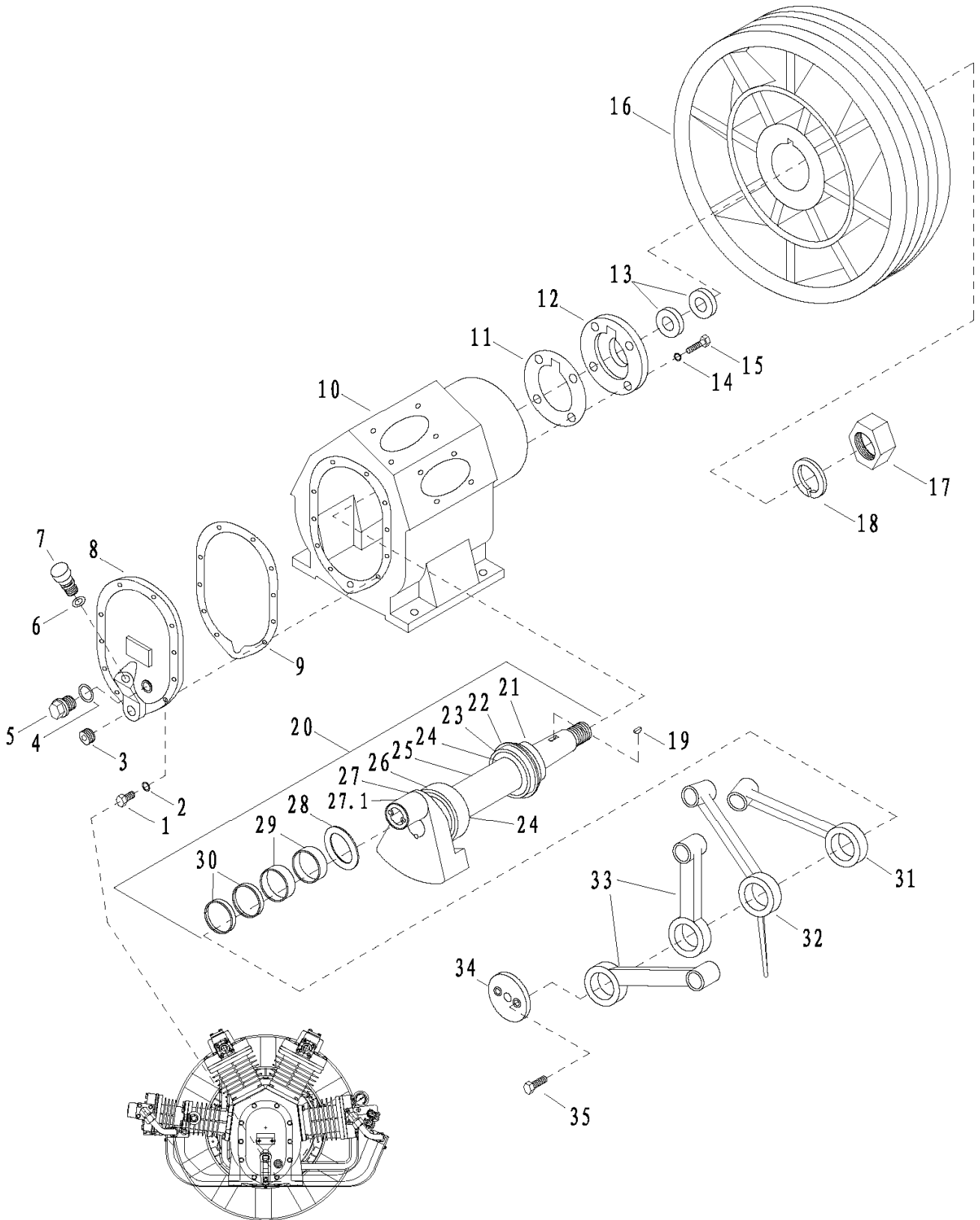

S/N	Specification & Code	Name	Qty	Remarks
1-01	M10*30-8.8	Bolt	10	
1-02	Flat washer 10	Flat washer	10	
1-03	JT.04.00.12	Oil discharging plug ZG1/2"	1	
1-04	O ring 25*3.55	O ring	1	
1-05	YB.01.00.00	Oil indicator M27*1.5	1	
1-06	O ring 23.5*3.55	O ring	1	
1-07	09.01.00.06	Oil filling cap	1	
1-08	09.SH.00.06	Crankcase cover	1	
1-09	09.SH.00.09	Paper gasket for Crankcase cover	1	
1-10	09.SH.01.00	Crankcase assy	1	
1-11	09.01.00.08	Paper gasket for bearing end cover	1	
1-12	09.01.00.A9	Bearing end cover	1	
1-13	FB45*62*12	Lip-type sealing ring	2	Need to stock
1-14	Flat washer 10	Flat washer	4	
1-15	M10*30-8.8	Bolt	4	
1-16	09.SH.00.10	Fan wheel	1	
1-17	Nut M30*2	Nut	1	
1-18	Spring washer 30	Spring washer	1	
1-19	Semicircula key 6*10*25	Key	1	
1-20	09.SH.05.00	Crankshaft assy	1	
1-21	09.04.00.05	Hot pressing circlip	1	
1-22	09.04.00.06	Stop circlip	1	
1-23	NUP309EN-TVP2	Bearing	1	
1-24	09.04.00.07	Washer	2	
1-25	09.04.00.04	Bushing	1	
1-26	NUP409E-TVP2	Bearing	1	
1-27	09.SH.05.01	Crankshaft components	1	
1-27.1	LOCTITE 620	glue	0.5	
1-28	09.04.00.08	Stop ring	1	
1-29	NA55*80*25-02	Inner ring 63.3*55*25	2	
1-30	NA55*80*18-02	Inner ring 63.3*55*18	2	
1-31	09.SH.04.01	connecting rod without oil needle 25GG(bearing included)	1	
1-32	09.SH.03.01	Connecting rod with long oil needle 25GG(bearing included)	1	
1-33	09.SH.02.01	Connecting rod without oil needle 17GG(bearing included)	2	
1-34	09.WM.00.04	Baffle plate, connecting rod	1	
1-35	Bolt M10*20	Bolt	2	

Breakdown Drawing 2: First-Stage Cylinder Piston Conrod Parts (2 sets)

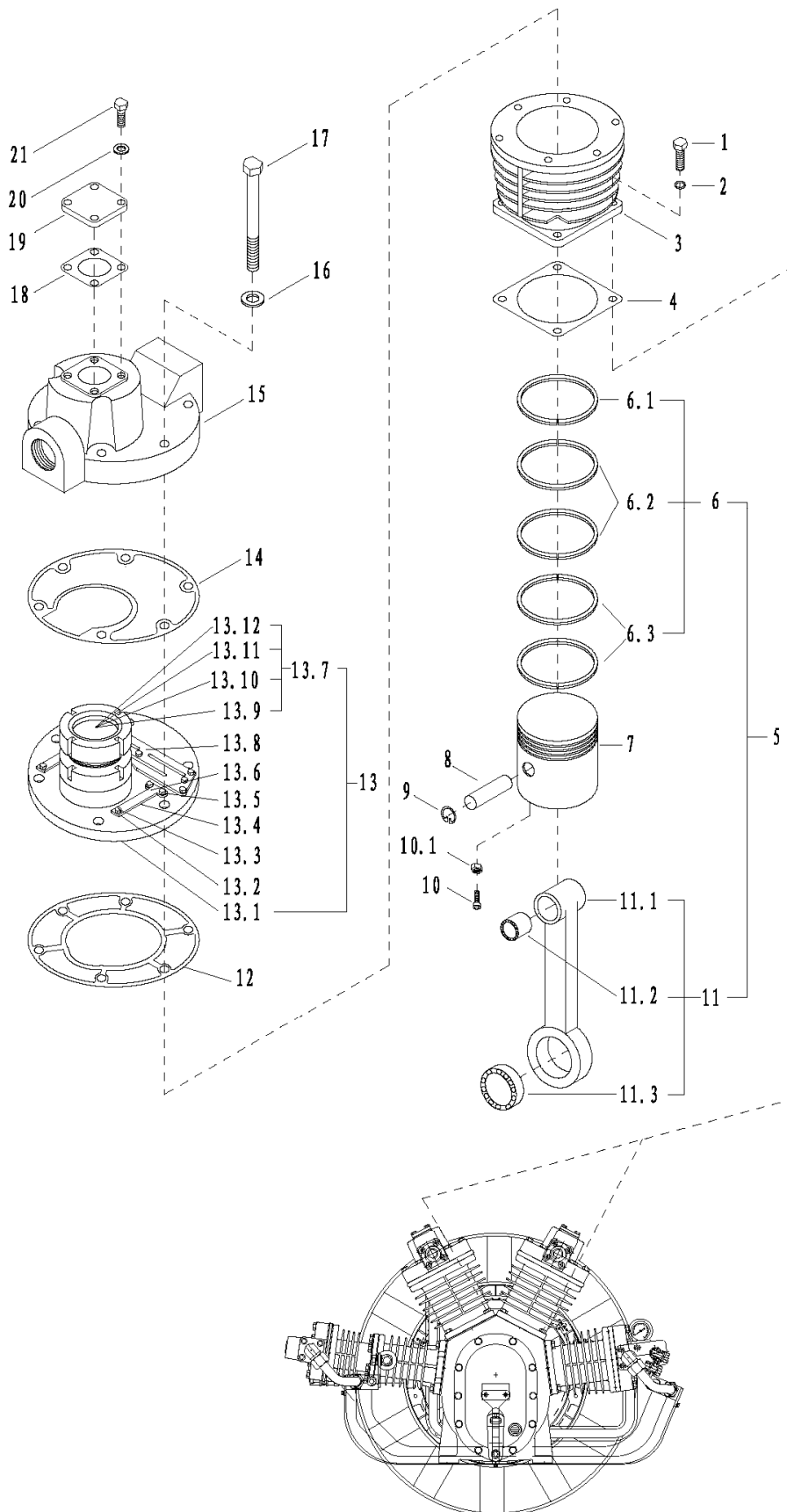

S/N	Specification & Code	Name	Qty	Remarks
2-01	M12*35-8.8	Bolt	4	
2-02	Flat washer 12	Flat washer	4	
2-03	09.01.00.15	1 st stage cylinder	1	
2-04	09.01.00.16	Cylinder gasket	1	
2-05	09.SH.02.00	1 st stage piston & connecting rod parts	1	
2-06	1 st stage Piston ring	Piston ring	1	
2-06.1	Barrel-face ring	Piston ring	1	
2-06.2	Taper-face ring	Piston ring	2	
2-06.3	Oil scraper ring	Piston ring	2	
2-07	09.02.00.06	1 st stage piston	1	
2-08	09.02.00.05	1 st stage piston pin	1	
2-09	Lockring 25	Lockring	2	
2-10	Bolt M8*25	Bolt	2	
2-10.1	Nut M8	Nut	2	
2-11	09.SH.02.01	Connecting rod without oil needle 17GG(bearing included)	1	
2-11.1	09.SH.00.03	Connecting rod shank without oil needle 17GG	1	
2-11.2	RNA6904 (RNA25x37x30)	Needle roller bearing	1	
2-11.3	NA55*80*18-01	Needle roller bearing 80*63.3*18	1	
2-12	09.01.00.14	Bottom gasket of the 1 st stage valve board	1	
2-13	09.06.00.00	1 st stage gas valve components	1	
2-13.1	09.06.00.01	1 st stage gas valve board	1	
2-13.2	11.06.00.03	Lift retainer washer 2	8	
2-13.3	Bolt M5*16-8.8	Bolt	13	
2-13.4	09.06.00.03	Reed valve plate 0.6	8	
2-13.5	11.06.00.04	Lift retainer washer 3	5	
2-13.6	09.07.00.03	Lift retainer board	2	
2-13.7	ZL.01.00.00	cylindrical direct-flow valve	1	
2-13.8	09.06.00.02	1 st stage lift retainer board	1	
2-13.9	ZL.01.01.00	Direct-flow valve core assy	1	
2-13.10	ZL.01.A0.04	Reed valve plate 0.457*4.1	10	
2-13.11	Bolt M4*6-8.8	Bolt	10	
2-13.12	O ring 57*2.65	O ring	1	
2-14	09.01.00.13	Upper gasket, 1 st stage valve board	1	
2-15	09.01.00.12	1 st stage cylinder cover	1	
2-16	Flat washer 12	Flat washer	6	
2-17	M12*65-8.8	Bolt	6	
2-18	XH.03.00.08	1 st & 2 nd stage unloading gasket	1	
2-19	07.01.00.13	Sealing cover	1	
2-20	Flat washer 8	Flat washer	4	
2-21	Bolt M8*20	Bolt	4	

Breakdown Drawing 3: Second Stage Cylinder Piston Conrod Parts (1 set)

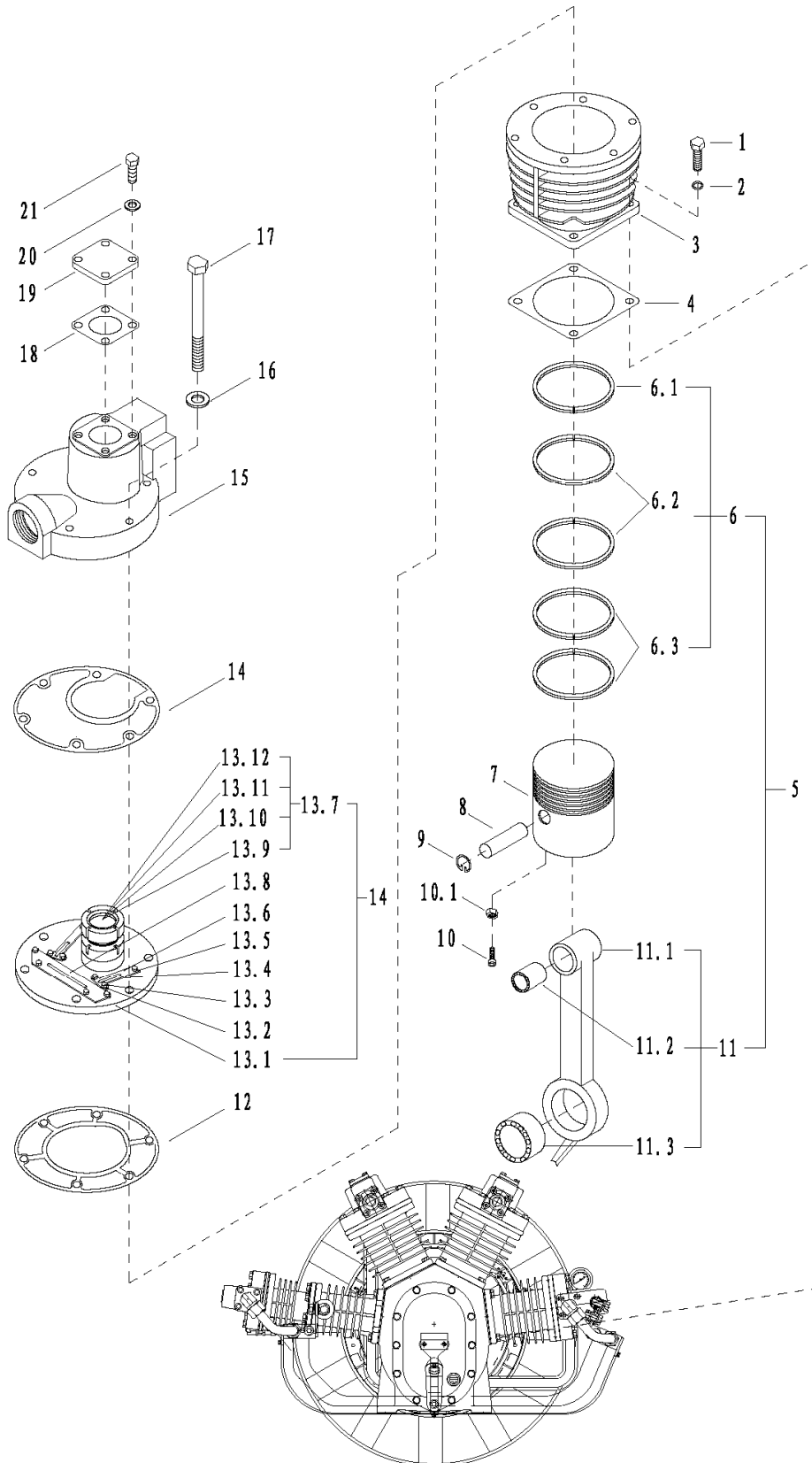

S/N	Specification & Code	Name	Qty	Remarks
3-01	M12*35-8.8	Bolt	4	
3-02	Flat washer 12	Flat washer	4	
3-03	09.01.00.17	2 nd stage cylinder	1	
3-04	09.01.00.16	Cylinder gasket	1	
3-05	09.SH.03.00	2 nd stage piston & connecting rod components	1	
3-06	2 nd stage piston ring	Piston ring	1	
3-06.1	Piston ring - chrome barrel	Piston ring	1	
3-06.2	Piston ring - chrome taper	Piston ring	2	
3-06.3	Piston ring - scrap oil	Piston ring	2	
3-07	09.03.00.02	2 nd stage piston	1	
3-08	09.03.00.06	2 nd stage piston pin	1	
3-09	Lockring 25	Locking	2	
3-10	Bolt M6*25	Bolt	2	
3-10.1	Nut M6	Nut	2	
3-11	09.SH.03.01	connecting rod with long oil needle 25GG(bearing included)	1	
3-11.1	09.SH.00.05	Connecting rod with long oil needle 25GG	1	
3-11.2	RNA6904	needle roller bearing	1	
3-11.3	NA55*80*25-01	needle roller bearing 80*63.3*25	1	
3-12	09.01.00.18	bottom gasket of the 2 nd stage valve board	1	
3-13	09.07.00.00	2 nd stage gas valve components	1	
3-13.1	09.07.00.01	2 nd stage gas valve board	1	
3-13.2	11.06.00.04	Lift retainer washer 3	5	
3-13.3	09.06.00.03	Reed valve plate 0.6*5.1	5	
3-13.4	11.06.00.03	Lift retainer washer 2	5	
3-13.5	Bolt M5*16-8.8	Bolt	10	
3-13.6	09.07.00.03	Lift retainer board	2	
3-13.7	ZL.02.00.00	Cylindrical direct-flow valve	1	
3-13.8	09.07.00.02	2 nd stage lift retainer board	1	
3-13.9	ZL.02.01.00	Valve core assy	1	
3-13.10	ZL.01.A0.04	Reed valve plate 0.457*4.1	8	
3-13.11	M4*6-8.8	Bolt	8	
3-13.12	O ring 43.7*2.65	O ring	1	
3-14	09.01.00.19	Upper gasket, 2 nd stage valve board	1	
3-15	09.01.00.20	2 nd stage cylinder cover	1	
3-16	Flat washer 12	Flat washer	6	
3-17	M12*65-8.8	Bolt	6	
3-18	XH.03.00.08	1 st & 2 nd stage unloading gasket	1	
3-19	07.01.00.13	Sealing cover	1	
3-20	Flat washer 8	Flat washer	4	
3-21	Bolt M8*20	Bolt	4	

Breakdown Drawing 4: Third Stage Cylinder Piston Conrod Parts (1 set)

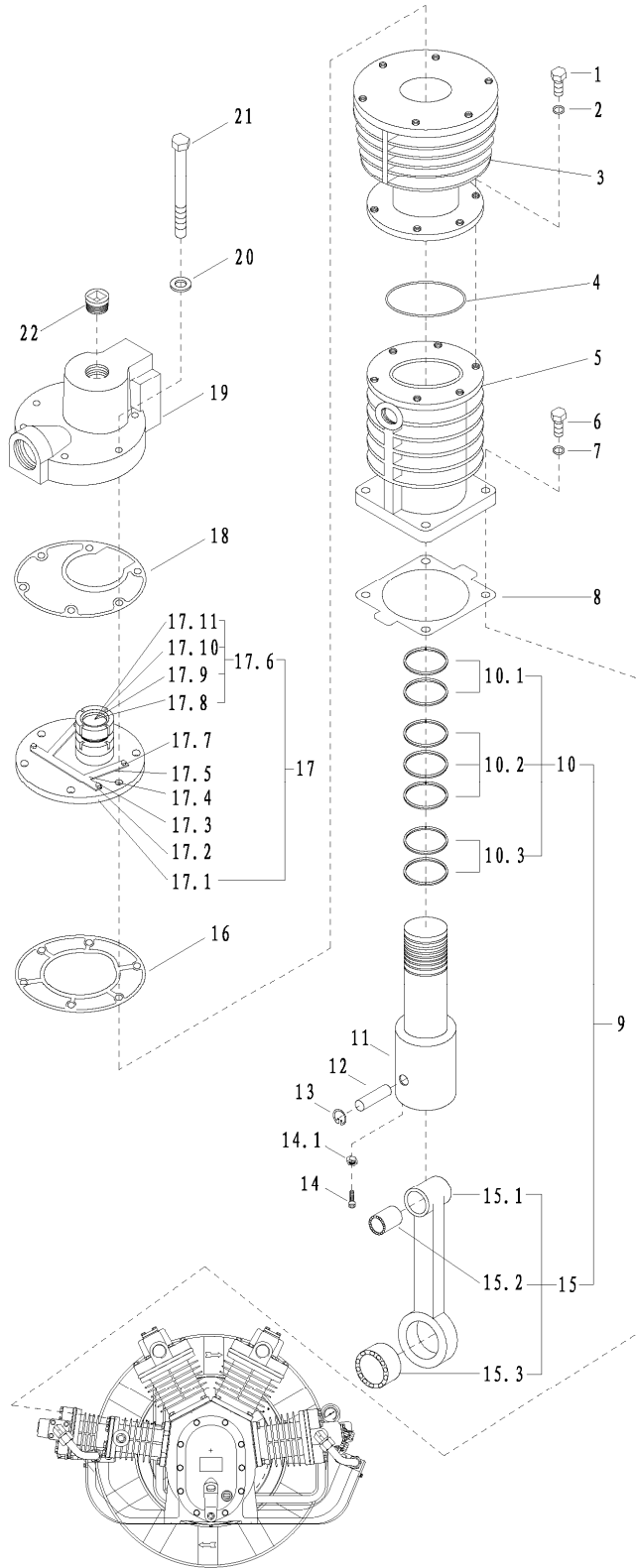

S/N	Specification & Code	Name	Qty	Remarks
4-01	Bolt M12*35-8.8	Bolt	6	
4-02	Flat washer 12	Flat washer	6	
4-03	31.01.00.01	3 rd stage cylinder	1	
4-04	O ring 85*2.65	O ring	1	
4-05	09.SH.00.08	Guide cylinder 80*190	1	
4-06	Bolt M12*35-8.8	Bolt	4	
4-07	Flat washer 12	Flat washer	4	
4-08	09.SH.00.07	bottom gasket of guide cylinder	1	
4-09	09.SH.04.00	3 rd stage piston & connecting rod parts	1	
4-10	3 rd stage piston ring	Piston ring	1	
4-10.1	Piston ring - chrome barrel	Piston ring	2	
4-10.2	Piston ring - chrome taper	Piston ring	3	
4-10.3	Piston ring - scrap oil	Piston ring	2	
4-11	31.01.00.02	3 rd stage piston	1	
4-12	40.04.00.03	3 rd stage piston pin	1	
4-13	Locking 25	Locking	2	
4-14	Bolt M6*25	Bolt	2	
4-14.1	Nut M6	Nut	2	
4-15	09.SH.04.01	Connecting rod without oil needle 25GG(bearing included)	1	
4-15.1	09.SH.00.05	Connecting rod shank without oil needle 25GG	1	
4-15.2	RNA6904	Needle roller bearing	1	
4-15.3	NA55*80*25-01	Needle roller bearing	1	
4-16	07.01.00.10	bottom gasket of the 2 nd valve board	1	
4-17	07.05.00.00	3 rd stage gas valve components	1	
4-17.1	07.05.00.01	2 nd stage gas valve board	1	
4-17.2	11.06.00.04	Lift retainer washer 3	1	
4-17.3	Bolt M5*16-8.8	Bolt	4	
4-17.4	07.05.00.02	2 nd stage lift retainer board	1	
4-17.5	30.02.00.01	Reed valve plate 0.8	3	
4-17.6	ZL.A3.00.00	Cylindrical direct-flow valve	1	
4-17.7	11.06.00.03	Lift retainer washer 2	3	
4-17.8	ZL.A3.01.00	Direct-flow valve core	1	
4-17.9	ZL.01.00.04	Reed valve plate 0.6	6	
4-17.10	Bolt M4*6-8.8	Bolt	6	
4-17.11	ZL.A3.00.07	copper pad	1	
4-18	34.01.00.01	Copper pad on 2 nd stage valve board	1	
4-19	07.01.00.12	2 nd stage cylinder cover	1	
4-20	Flat washer 12	Flat washer	6	
4-21	M12*65-8.8	Bolt	6	
4-22	JT.04.00.02	Screw plug ZG1"	1	

Drawing 5: intercoolers

Outline drawing of the finned pipe

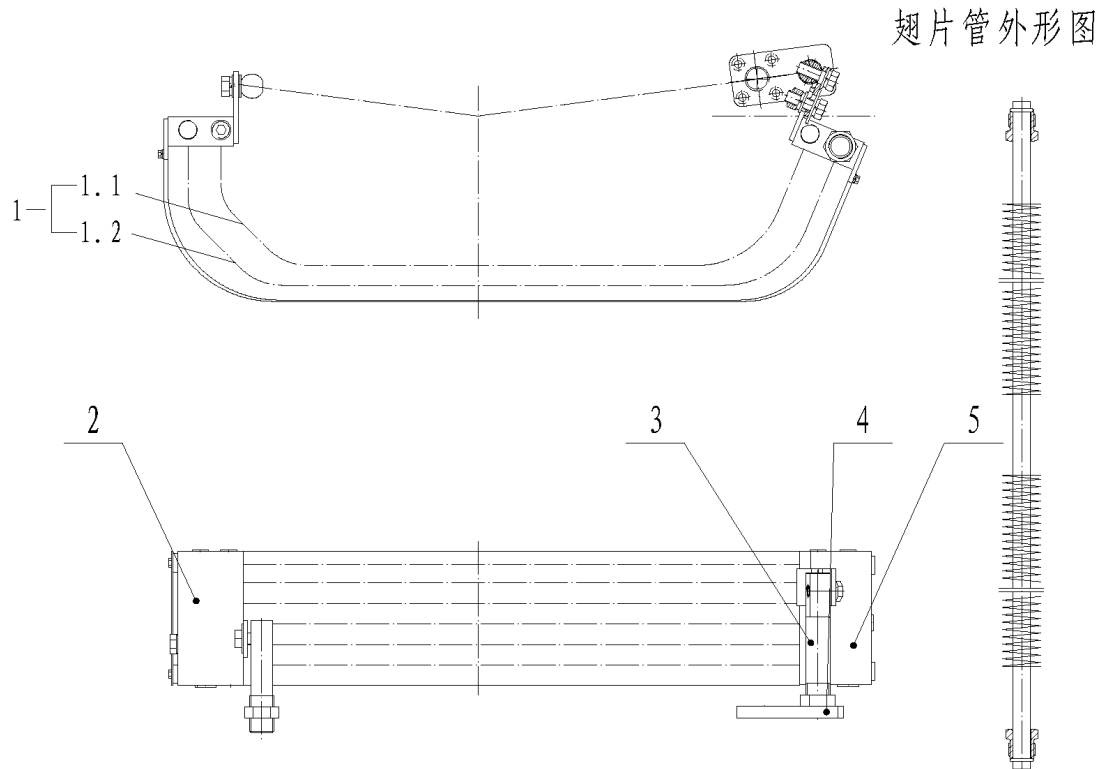

S/N	Specification & Code	Name	Qty	Remarks
5-1	09.SH.06.A3	Finned pipes of 2 nd stage to 3 rd stage	1 set	
5-1.1	09.SH.06.A3-1	Finned pipes 998(471+527)	6	
5-1.2	09.SH.06.A3-2	Finned pipes 1124(539+585)	6	
5-2	83.05.00.04	Intercooler left gas collecting strip	1	
5-3	34.SH.00.03	Hanging rod	1	
5-4	34.SH.00.01	Intermediate board at the inlet of 2 nd stage	1	
5-5	83.05.00.03	Intercooler right gas collecting strip	1	

**Figure 6: Circuit Diagram of 34S Series Single Unit (standard supply)
(DQ.11.00.00 electric cabinet of single unit)**

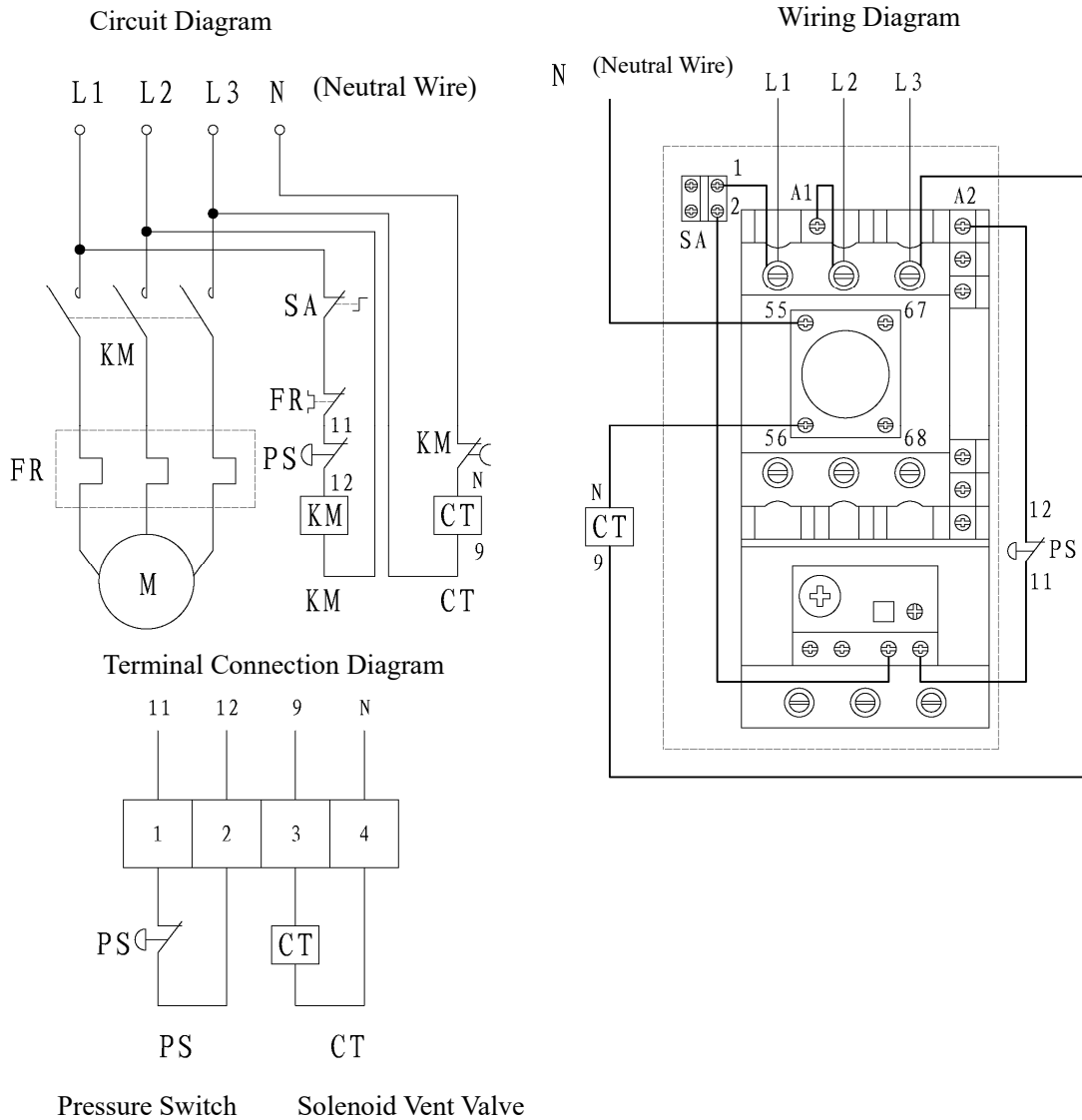

Notes: KM	AC Contactor	FR	Thermal Relay
SA	Knob Switch	CT	Solenoid Vent Valve

S/N	Code	Name	Brand	Remarks
6-01	CJX2-5011/380V	AC contactor	CHINT	15KW
6-02	JRS1-40-80/Z-40A	Thermal relay	CHINT	15KW
6-03	CJX2-6511/380V	AC contactor	CHINT	18.5KW
6-04	JRS1-40-80/Z-50A	Thermal relay	CHINT	18.5KW
6-05	NP2-ED25	Option button	CHINT	

Table 7: Complete Sealing Gasket List of 34SH Machine Head

(a summary for the above-mentioned sealing gaskets)

S/N	Code	Name	Qty	Remarks
7-01	09.SH.00.09	Crankcase cover gasket	1	Need to stock
7-02	09.01.00.08	Bearing end cover gasket	1	Need to stock
7-03	09.01.00.16	Cylinder gasket	3	Need to stock
7-04	09.SH.00.07	Bottom gasket of the guide cylinder	1	Need to stock
7-05	09.05.00.24	Gas collector gasket	3	Need to stock
7-06	09.01.00.14	Bottom paper gasket, 1 st stage valve board	2	Need to stock
7-07	09.01.00.13	Upper paper gasket, 1 st stage valve board	2	Need to stock
7-08	07.01.00.10	Bottom paper gasket, 2 nd stage valve board	1	Need to stock
7-09	09.01.00.19	upper paper gasket, 2 nd stage valve board	1	Need to stock
7-10	09.01.00.18	Bottom paper gasket, 2 nd stage valve board	1	Need to stock
7-11	34.01.00.01	upper red copper pad, 2 nd valve board	1	Need to stock